

**GENERAL MEETING OF THE BOARD OF DIRECTORS
OF THE
CENTRAL TEXAS REGIONAL MOBILITY AUTHORITY**

RESOLUTION NO. 07-35

WHEREAS, the Central Texas Regional Mobility Authority ("CTRMA") was created pursuant to the request of Travis and Williamson Counties and in accordance with provisions of the Transportation Code and the petition and approval process established in 43 Tex. Admin. Code § 26.01, *et. seq.* (the "RMA Rules"); and

WHEREAS, Chapter 370 of the Texas Transportation Code authorizes regional mobility authorities to develop projects through the use of comprehensive development agreements ("CDAs"); and

WHEREAS, the CTRMA solicited proposals for the development of 183-A and in Resolution No. 04-43, dated September 8, 2004, the Board of Directors approved the selection of Hill Country Constructors as the Developer for 183-A, and the CTRMA and Hill Country Constructors entered into a CDA effective November 29, 2004 for the 183-A Turnpike Project; and

WHEREAS, the work performed under the CDA requires oversight by the General Engineering Consultant retained by the CTRMA (the "GEC"); and

WHEREAS, the CDA includes a process for the consideration and development of potential change orders for aspects or portions of the work performed under the CDA which might warrant adjustment to the Development Price or the contractual deadlines for performance by the Developer; and

WHEREAS, the change order process includes consideration of potential changes or revisions caused by several sources or events, including certain requests for changes by the CTRMA, certain otherwise undiscovered matters affecting the 183-A Project, as well as other items more fully set forth in the CDA; and

WHEREAS, the CDA provides that all change orders be formally agreed to by the CTRMA and the Developer, and that except those involving an amount up to and including \$50,000.00 as set forth in Resolution No. 05-46 dated June 29, 2005, the Board must approve any change order; and

WHEREAS, the CTRMA, the GEC and the Developer, pursuant to the change order process set forth in the CDA, have determined that the construction of additional improvements to the north bound frontage road between FM 1431 and Medical Parkway require the issuance of Change Order No. 24, as set forth and in accordance with the terms thereof and attached hereto as Attachment "A."

NOW THEREFORE, BE IT RESOLVED, that the Board of Directors approves Change Order No. 24 as set forth and in accordance with the terms in Attachment "A" attached hereto and hereby authorizes the Executive Director to finalize the terms associated with Change Order No. 24 and execute Change Order No. 24 as appropriate; and

BE IT FURTHER RESOLVED, that upon proper execution by all of the appropriate parties in accordance with the CDA, Change Order No. 24 shall be made an amendment to the Contract Documents, as defined in the CDA, as of the date that Change Order No. 24 is fully executed.

Adopted by the Board of Directors of the Central Texas Regional Mobility Authority on the 25th day of July, 2007.

Submitted and reviewed by:



Tom Nielson
General Counsel for the Central
Texas Regional Mobility Authority

Approved:



Robert E. Tesch
Chairman, Board of Directors
Resolution Number 07-35
Date Passed 7/25/07

Attachment "A"

Copy of Change Order No. 24 Memorandum and Summary

HNTB

M e m o r a n d u m

To: Mike Heiligenstein
Bill Chapman

Date: July 23, 2007

From: Richard Ridings

Subject: Change Order No. 024 – Construction of Curb & Gutter Improvements on the Northbound Frontage Road Between FM 1431 and Medical Parkway

Copies: Tom Nielson, Everett Owen, Ron Fagan

This attached Change Order (CO) No. 024 is in the amount of \$ 187,459.00. This change order compensates HCC for the construction improvements to the northbound frontage road between FM 1431 and Medical Parkway.

The GEC has reviewed the subject CO and recommends approval.

EXHIBIT M
FORM OF CHANGE ORDER

CHANGE ORDER PROPOSAL NO. 024 CONTRACT NO. 183A Turnpike

SECTION 1

Originator: Rich Ginder

Date: July 23, 2007

Title: Project Scheduler

Contract No. 183A Turnpike

Company Name: Hill Country Constructors

DESCRIPTION:

This change order compensates HCC for the construction improvements to the northbound frontage road between FM 1431 and Medical Parkway. The plans for the frontage road improvements are shown in Exhibit 24.3.

Scope:

The cost for this change order was based on design drawings provided by the CTRMA as shown in Exhibit 24.3. The CTRMA is responsible for the following items:

- Design of the roadway improvements along the NBFR between FM 1431 and Medical Parkway.
- Public Involvement
- Utility Adjustment and Coordination

HCC pricing includes the following items:

- Removal and replacement of topsoil along the west side of the frontage road
- Removal of existing curb and gutter and roadway pavement to accommodate the new curb construction.
- Earthwork and grading.
- 8" Type 1 or equivalent flexible base. HCC already placed flexible base outside the edges of the existing pavement, however there may be some additional base required to accommodate this change order work. The CTRMA agreed to pay \$143/CY of delivered flexible base to complete the needs for the roadway improvements.
- 5.5" of Type B Hot Mix Asphalt Pavement in areas of roadway widening.

- 2" of Type C Hot Mix Asphalt Pavement in between the new curb and the existing roadway asphalt surface.
- Approximately 2,852 LF of curb and gutter. All curb and gutter will be hand formed along the saw-cut edge of pavement.
- 15 open back curb inlets along the west side of the frontage road.
- Construction Quality Assurance
- Striping.
- Signing.
- Traffic Control – Approximately 34 days of lane closures will be needed to complete this change order work. The CTRMA agreed to pay the cost of the final invoices by United Rentals for the traffic control of this change order after the work is complete.

Additional Terms:

This change order includes pricing allowances for the settlement of the fiber connection line from SH-45 section 8 mainline toll plaza to the CTRMA's old office at the Briarwick location. Both parties agree to waive all claims for changes in the development price associated with the Briarwick office fiber connection line.

CAUSE OF CHANGE ORDER REQUEST:

CTRMA requested HCC to provide pricing for the work of the improvements of the northbound frontage road between FM 1431 and Medical Parkway. The result of this request came from some communication between the adjacent land developer and the CTRMA.

Developer Project Manager Date

**CHANGE ORDER
REQUEST**

CHANGE ORDER PROPOSAL NO. 024

CONTRACT NO. 183A Turnpike

SECTION II

The total amount of this Change Order is \$ 187,459.00. Documentation supporting the Change Order is attached as Exhibits CO.24.1 through CO.24.5.

Payment Schedule Items Added/Deducted:

<u>Activity No.</u>	<u>Description</u>	<u>Quantity</u>	<u>UM</u>	<u>Unit Price</u>	<u>Extended Amount</u>
B069934	Earthwork, Pavement Removal, and Toposil – Medical Pkwy - CO #24	1	LS	\$27,473.00	\$27,473.00
B071991	Flexbase – Medical Parkway – CO #24	140*	CY	\$143.00	\$20,021.00
B085283	HMA Paving B,C – Medical Parkway – CO #24	1	LS	\$4,998.00	\$4,998.00
B094629	Open Back Inlets – Medical Parkway – CO #24	15	EA	\$3,085.27	\$46,279.00
B105440	Curb and Gutter – Medical Parkway – CO #24	2,580	LF	\$17.99	\$46,416.00
B105431	Lane Closures – Medical Parkway – CO #24	34**	DY	\$529.65	\$18,008.00
A021042	Construction QA – Medical Parkway – CO #24	1	LS	\$7,449.00	\$7,449.00
A011189	Medical Parkway – Survey, Labor Escalation,	1	LS	\$6,475.00	\$6,475.00
B116437	Striping – Medical Parkway - CO #24	1	LS	\$4,101.00	\$4,101.00
B116438	Signing – Medical Parkway - CO #24	1	LS	\$6,239.00	\$6,239.00

* - The quantity of flexible base will be determined by actual delivered quantity required for this change order. Final payment will be adjusted to match the actual delivered quantity at \$143/CY.

** - The final payment for the traffic control will be determined by the invoice from United Rentals to perform the traffic control lane closures resulting from this change order.

Summary of Change Order Proposal by Categories: [Additives/(Credits)]

A.	Developer Labor (construction)		
1.	Wages ¹	\$	25,748.00
2.	Labor benefits ² (55% of A.1)	\$	14,161.00
B.	Developer and Subcontractor Labor (professional services)		
1.	Wages ¹ (Raw)	\$	0.00
2.	Labor benefits ² (145% of B.1, which includes overhead and profit)	\$	0.00
3.	Off-duty peace officers and patrol cruisers ¹	\$	0.00
C.	Materials ¹ (with taxes, freight and discounts)	\$	4,070.00
D.	Developer Equipment ¹	\$	1,684.00**
E.	Subcontracts ¹ (Time and Materials costs)	\$	129,722.00
F.	Utility Direct Costs ¹	\$	0.00
G.	Overhead and Profit		
1.	Labor (25% of A.1 and A.2)	\$	4,977.00
2.	Traffic Control (5% of B.3)	\$	0.00
3.	Materials (15% of C)	\$	611.00
4.	Subcontracts (5% of E)	\$	6,486.00
5.	Utility Direct Costs (5% of F)	\$	0.00

¹ Estimated for Negotiated Change Orders or Actual for Force Account Change Orders.

² Premiums on public-liability and workers-compensation insurance, social-Security and unemployment-insurance taxes.

H.

Grand Total

\$ 187,459.00

**CHANGE ORDER
REQUEST**

CHANGE ORDER PROPOSAL NO. 024

CONTRACT NO. 183A Turnpike

SECTION III

The status of Substantial Completion is as follows:

- Unaffected by this Change Order Proposal

The status of Final Acceptance is as follows:

- This work is scheduled to be completed in conjunction with the schedule for the subdivision wall added by change order no. 19 with additional time granted by change order no. 20. HCC's schedule execution for this change order is directly dependent on the following items by the CTRMA: 1) Finalize design; and 2) CTRMA Board Approval on July 25, 2007. If delays to these items cause the work to extend beyond October 30, 2007 the CTRMA will grant additional time and overhead at the monthly rate established in change order no. 20.

Accordingly, the summary of the dates of Substantial Completion and Final Acceptance and Float are as follows:

1. Substantial Completion: Unchanged
(+ or - _____ days from base of _____ calendar days after NTP2)
2. Final Acceptance: Unchanged
(+ or - _____ days from base of 850 calendar days after NTP2)
3. Number of days of Project Float Unchanged

Justification for Change Order with reference to CDA:

CDA Section 14.3 allows Developer to request a change order to increase the development price for increased costs associated with CTRMA-Directed Changes which increase the work to be furnished, performed, or paid for by the developer.

The above three sections represent a true and complete summary of all aspects of this change.

This Change Order Proposal includes all known and anticipated impacts or amounts, direct, indirect and consequential, which may be incurred as a result of the event, occurrence or matter giving rise to the proposed change.

**CHANGE ORDER
REQUEST**

CHANGE ORDER PROPOSAL NO. 024

CONTRACT NO. 183A Turnpike

If the foregoing Change Order Proposal includes claims of Subcontractors or Suppliers, the undersigned have reviewed such claims and have determined in good faith that the claims are justified as to both entitlement and amount.

Developer Project Manager

Date

**CHANGE ORDER
REQUEST**

CHANGE ORDER PROPOSAL NO. 024

CONTRACT NO. 183A Turnpike

SECTION IV (Reviewed by GEC Manager)

GEC Team Construction Manager (CDA) Date

Comments:

**CHANGE ORDER
REQUEST**

CHANGE ORDER PROPOSAL NO. 024

CONTRACT NO. 183A Turnpike

SECTION V (Reviewed by GEC Project General Engineer)

Project General Engineer (CDA)

Date

Comments:

**CHANGE ORDER
REQUEST**

CHANGE ORDER PROPOSAL NO. 024

CONTRACT NO. 183A Turnpike

SECTION VII (Approval by CTRMA)

CHANGE ORDER ISSUED: Yes No

CTRMA Executive Director

Date

Comments:

**Exhibit CO.24.1
Cost Breakdown Spreadsheet**

EXHIBIT M

Medical Parkway Request for Cost Proposal - Hand Curb Option

A. DEVELOPER LABOR (CONSTRUCTION)	
1. WAGES	12,845
2. LABOR BENEFITS (55% OF A.1)	7,065
B. DEVELOPER AND SUBCONTRACTOR LABOR (PROFESSIONAL SERVICES)	
1. WAGES	-
2. LABOR BENEFITS (145% OF B.1)	-
3. OFF-DUTY PEACE OFFICERS AND PATROL CRUISERS	-
C. MATERIALS	4,070
D. EQUIPMENT	21,684
E. SUBCONTRACTS	129,722
F. UTILITY DIRECT COSTS	-
G. OVERHEAD & PROFIT	
1. LABOR (25% OF A.1 and A.2)	4,977
2. TRAFFIC CONTROL (5% OF B.3)	-
3. MATERIALS (15% OF C)	611
4. SUBCONTRACTS (5% OF E)	6,486
5. UTILITY DIRECT COSTS (5% OF F)	-
H. GRAND TOTAL	187,459

US 183A

Medical Parkway Request for Cost Proposal - Hand Curb Option

ITEM	DESCRIPTION	UOM	ORIGINAL QUANTITY	PROPOSED QUANTITY	DELTA	UNIT COST	A.1	B.1	C	D	E	TOTAL	TOTAL w/ Markups
							LABOR	PROF SERV	MATL	EQUIP	SUB		
001	DEMOLITION AND REMOVAL	SY	-	1,425	1,425	9.18	2,106	-	100	6,585	4,296	13,087	15,291
001A	REMOVING CURB AND GUTTER	LF	-	33	33	7.06	48	-	-	185	-	233	278
001B	REMOVING CONC (C&G)	LF	-	110	110	7.69	161	-	-	685	-	846	997
001C	HAUL OFF CONCRETE DEMO	LD	-	1	1	420.00	-	-	100	320	-	420	435
001D	REMOVING STAB BASE AND PAVING	SY	-	634	634	8.98	1,897	-	-	3,795	-	5,692	7,470
001E	HAUL OFF ASPHALT/BASE	LD	-	14	14	114.29	-	-	-	1,600	-	1,600	1,600
001D	SAWCUT EXISTING ASPHALT	LF	-	3,124	3,124	1.38	-	-	-	-	4,296	4,296	4,511
002	EARTHWORK	CY	-	362	362	27.51	2,271	-	-	5,817	1,871	9,959	12,182
002A	EXCAVATE FOR CURB	LF	-	1,416	1,416	0.62	436	-	-	438	-	874	1,283
002B	EMBANKMENT	CY	-	362	362	13.70	1,067	-	-	3,894	-	4,961	5,961
002C	REMOVE EXISTING TOPSOIL	CY	-	93	93	10.12	206	-	-	735	-	941	1,134
002D	SPREAD TOPSOIL	CY	-	93	93	6.05	227	-	-	336	-	563	776
002E	FINISH TOPSOIL	SY	-	833	833	3.15	335	-	-	414	1,871	2,620	3,028
003	FLEXIBLE BASE - 8"	CY	-	140	140	113.10	3,897	-	3,160	7,595	1,182	15,834	20,021
<i>It is not certain until work is completed how much of the existing flexbase can be utilized. The CTRMA agreed to pay \$143.00/CY with markups for the actual amount of flexbase that is additional for this change order.</i>													
003A	BASE COURSE MATERIALS	TN	-	273	273	15.90	-	-	3,160	-	1,182	4,342	4,875
003B	PREP GRADE	SY	-	630	630	9.38	2,029	-	-	3,883	-	5,912	7,814
003C	PLACE AND FINISH BASE	TN	-	273	273	20.44	1,868	-	-	3,712	-	5,580	7,331
004	AC PAVEMENT	TN	-	13	13	280.31	1,347	-	610	1,687	-	3,644	4,998
004A	ASPHALT MATERIALS	TN	-	13	13	77.69	-	-	610	400	-	1,010	1,102
004B	HAND PLACE ASPHALT	TN	-	13	13	202.62	1,347	-	-	1,287	-	2,634	3,897
005	CURB AND GUTTER	LF	-	2,852	2,852	15.50	-	-	-	-	44,206	44,206	46,416
005A	CURB AND GUTTER - AARON'S HAND POUR	LF	-	2,852	2,852	15.50	-	-	-	-	44,206	44,206	46,416
006	DRAINAGE	LS	-	1	1	44,075.00	-	-	-	-	44,075	44,075	46,279
006A	TY C - 5' OPEN BACK CURB INLETS	EA	-	9	9	2,550.00	-	-	-	-	22,950	22,950	24,098
006B	TY C - 10' OPEN BACK CURB INLETS	EA	-	5	5	3,375.00	-	-	-	-	16,875	16,875	17,719
006C	TY C - 15' OPEN BACK CURB INLETS	EA	-	1	1	4,250.00	-	-	-	-	4,250	4,250	4,463
007	STRIPING	LS	-	1	1	3,906.00	-	-	-	-	3,906	3,906	4,101
007A	REFL PAV MRK TY I (W) 4" BRK	LF	-	627	627	0.31	-	-	-	-	194	194	204
007B	REFL PAV MRK TY I (W) 4" SLD	LF	-	181	181	0.28	-	-	-	-	51	51	54
007C	REFL PAV MRK TY I (W) 8" SLD	LF	-	181	181	0.60	-	-	-	-	109	109	114
007C	REFL PAV MRK TY I (Y) 4" SLD	LF	-	275	275	0.30	-	-	-	-	83	83	87
007D	REFL PAV MRK TY II C-R	EA	-	31	31	3.94	-	-	-	-	122	122	128
007E	ELIMINATE PAV MRK 4"	SY	-	3,055	3,055	0.85	-	-	-	-	2,597	2,597	2,727
007F	MOBILIZATION	EA	-	1	1	750.00	-	-	-	-	750	750	788

ITEM	DESCRIPTION	UOM	ORIGINAL QUANTITY	PROPOSED QUANTITY	DELTA	UNIT COST	A.1	B.1	C	D	E	TOTAL	TOTAL w/ Markups
							LABOR	PROF SERV	MATL	EQUIP	SUB		
008	SIGNING	LS	-	1	1	5,942.00	-	-	-	-	5,942	5,942	6,239
008A	SMALL SIGNS	LS	-	1	1	5,942.00	-	-	-	-	5,942	5,942	6,239
009	TRAFFIC CONTROL	LS	-	1	1	17,150.00	-	-	-	-	17,150	17,150	18,008
<i>The CTRMA agreed to pay United Rentals per actual lane closure needed for complete this change order work.</i>													
009A	LANE CLOSURE AND MESSAGE BOARD - UR	DAY	-	34	34	504.41	-	-	-	-	17,150	17,150	18,008
010	INCIDENTALS	LS	-	1	1	10,517.62	3,224	-	200	-	7,094	10,518	13,924
010A	SURVEY PERSONNEL	MO	-	0.2000	0.2000	14,060.00	2,612	-	200	-	-	2,812	5,291
010B	LABOR ESCALATION 5%	%	-	0.0500	0.0500	12,233.00	612	-	-	-	-	612	1,185
010C	CONSTRUCTION QA	LS	-	1	1	7,093.97	-	-	-	-	7,094	7,094	7,449
TOTAL CONSTRUCTION COSTS							12,845	-	4,070	21,684	129,722	168,321	187,459

Exhibit CO.24.2
Detailed Cost Estimate of Request for Cost Proposal

ITEM	DESCRIPTION	QUANTITY	UNIT COST	LABOR	MATERIAL	EQUIPMENT	SUBCONTRACT	TOTAL
AC&GNBFR	MEDICAL PARKWAY - HAND CURB OPT	1.000 LS	168,321.700	12,847	4,069	21,684	129,721	168,322
	662.7 MAN-HOURS			PERM MATL. 3,769				
				JOB MATL. 300				
001	DEMOLITION AND REMOVAL	634.000 SY	20.642	2,107	100	6,585	4,296	13,087
	120.7 MAN-HOURS			PERM MATL.				
	MEDICAL PARKWAY CURB AND GUTTER - TAKEOFFS			JOB MATL. 100				

STATION	Edge of Pavement Original	Offsets Proposed	Difference	Distance Remove LF	Remove LF	C&G Sawcut INF	AC Remove SY
159,040	8	12	4				
159,060	8	12	4	20		110	9
159,183	8	8	0	123	123	677	55
159,311	8	8	0	128	0	704	57
159,391	8	8	0	80	0	440	36
159,938	8	8	0	547	0	3,009	243
160,019	8	8	0	81		446	
160,567	8	6	-2	548	0	3,014	304
160,617	2	0	-2	50	0	275	33
159,040	-28	-28	0				
159,988	-28	-28	0	948	0	5,214	421
160,300	-40	-40	0	312	0	1,716	139
160,527	-40	-40	0	227	0	1,249	101
160,588	-38	-38	0	61	0	336	27
TOTALS				3125	123	17188	1425

ITEM	DESCRIPTION	QUANTITY	UNIT COST	LABOR	MATERIAL	EQUIPMENT	SUBCONTRACT	TOTAL
AC&GNBFR MEDICAL PARKWAY - HAND CURB OPT - CONTINUED...								
001A	REMOVING CONC CURB	33.000 LF	7.083	48		185		234
5/10.0/1--- P - DAYS: 0.08 PROD. RATE: 40.00 LF/HR								
2.5 MAN-HOURS 13.333 LF PER MAN-HOUR 0.075 MAN-HOURS PER LF								
					PERM MATL.			
					JOB MATL.			
01	OPERATOR FOREMAN 2006	L	1.000	0.649	21			
02	FOREMAN'S PICKUP (HR)	E	1.000	0.184		6		
03	EXCAVATOR OPERATOR 2006	L	1.000	0.457	15			
04	JD 710 G BACKHOE (2005)	E	1.000	1.373		45		
05	FRONT END LOADER OPR 06	L	1.000	0.360	12			
06	CAT 950 F LOADER (1991)	E	1.000	1.030		34		
07	EQUIPMENT LOADER MOVE	e/	0.100 EA	500.000		50		
08	EQUIPMENT BACKHOE MOVE	e/	0.100 EA	500.000		50		
001B	REMOVING CONC (C&G)	110.000 LF	7.689	161		685		846
5/10.0/1--- P - DAYS: 0.28 PROD. RATE: 40.00 LF/HR								
8.3 MAN-HOURS 13.333 LF PER MAN-HOUR 0.075 MAN-HOURS PER LF								
					PERM MATL.			
					JOB MATL.			
01	OPERATOR FOREMAN 2006	L	1.000	0.649	71			
02	FOREMAN'S PICKUP (HR)	E	1.000	0.184		20		
03	EXCAVATOR OPERATOR 2006	L	1.000	0.457	50			
04	JD 710 G BACKHOE (2005)	E	1.000	1.373		151		
05	FRONT END LOADER OPR 06	L	1.000	0.360	40			
06	CAT 950 F LOADER (1991)	E	1.000	1.030		113		
07	EQUIPMENT LOADER MOVE	e/	0.400 EA	500.000		200		
08	EQUIPMENT BACKHOE MOVE	e/	0.400 EA	500.000		200		
001C	HAUL OFF CONCRETE DEMO	4.000 LD	105.000		100	320		420
5/10.0/1--- P - DAYS: 0.80 PROD. RATE: 0.50 LD/HR								
					PERM MATL.			
					JOB MATL.			
01	AVERAGE HAUL=	30MILES			100			
CONCRETE RECYCLER SITE AT FM 973 AND SH 71 NEAR BERGSTROM								
	LOAD	5.0 MIN						
	HAUL	32.7 MIN	SPEED @	55 MPH				
	DUMP	10.0 MIN						
	RETURN	32.7 MIN	SPEED @	55 MPH				

 ITEM DESCRIPTION QUANTITY UNIT COST LABOR MATERIAL EQUIPMENT SUBCONTRACT TOTAL

AC&GNBFR MEDICAL PARKWAY - HAND CURB OPT - CONTINUED...

TRAFFIC 20.0 MIN
 TOTAL 100.5 MIN

USE 55 MIN/HOUR
 0.5 LOADS/HOUR
 13.0 TN/LOAD
 7.1 TN/HOUR

02 DUMP FEE	j/	4.000 LD	25.000				
03 10 WHEEL END DUMP, 13T (OO)	E	1.000	80.000		100		
						320	
001D REMOVING STAB BASE AND AC PAVE		634.000 SY	8.978	1,897		3,795	5,692

5/10.0/1--- D - DAYS: 2.00 PROD. RATE: 31.70 SY/HR
 110.0 MAN-HOURS 5.764 SY PER MAN-HOUR 0.174 MAN-HOURS PER SY
 PERM MATL.
 JOB MATL.

01 FIGURE REMOVING 5.5" OF HCC PLACED ACP

AREA OF REMOVAL 634SY
 ACP THICKNESS 5.5IN
 VOLUME OF REMOVAL 97CY
 VOLUME PER LOAD 7CY

LOADS 14EA

02 OPERATOR FOREMAN 2006	L	1.000	0.819	519		
03 FOREMAN'S PICKUP (HR)	E	1.000	0.232			
04 EXCAVATOR OPERATOR 2006	L	1.000	0.576	365		147
05 JD 710 G BACKHOE (2005)	E	1.000	1.732			
06 EXCAVATOR OPERATOR 2006	L	0.500	0.288	183		1,098
07 CAT 330CL BACKHOE (2002)	E	0.500	1.826			
08 HOERAM ATTACH (8400LB) (O)	E	0.500	1.407			1,158
09 GENERAL LABOR 2006	L	3.000	1.309	830		892
10 EQUIPMENT LOADER MOVE	e/	0.500 EA	500.000			250
11 EQUIPMENT BACKHOE MOVE	e/	0.500 EA	500.000			250

305 HCD TEXAS REGIONAL OFFICE GRANITE CONSTRUCTION INCORPORATED
 BID BODY BID INTERACTIVE DEVELOPMENT SYSTEM 2 (V 4.73) VER. #1.000
 BID DATE: 09/30/04 JOB 183A1205 : US 183A - NORTH TIE-IN ALTERNATE F ADD. #

PAGE: 4
 RUN DATE: 07/23/07
 RUN TIME: 14:10

 ITEM DESCRIPTION QUANTITY UNIT COST LABOR MATERIAL EQUIPMENT SUBCONTRACT TOTAL

 AC&GNBFR MEDICAL PARKWAY - HAND CURB OPT - CONTINUED...

001E HAUL OFF ASPHALT / BASE 14.000 LD 114.286 1,600 1,600

5/10.0/1--- D - DAYS: 2.00 PROD. RATE: 0.70 LD/HR PERM MATL.
 JOB MATL.

01 ANALYSIS OF TRUCK HAUL FOR IDEAL LOADING AND HAULING CONDITIONS
 AVERAGE HAUL= 25MILES WASTE MANAGEMENT IN HUTTO WILL TAKE BASE AND ASPHALT AT NO CHARGE.

LOAD 5.0 MIN
 HAUL 27.3 MIN SPEED @ 55 MPH
 DUMP 10.0 MIN
 RETURN 27.3 MIN SPEED @ 55 MPH
 TRAFFIC 20.0 MIN
 TOTAL 89.5 MIN

USE 55 MIN/HOUR
 0.6 LOADS/HOUR
 7.0 CY/LOAD
 4.3 CY/HOUR

02 FIGURE RUNNING 2 TRUCKS THROUGHOUT THE DURATION OF THE REMOVING ASPHALT AND STABILIZED BASE ACTIVITY.
 03 10 WHEEL END DUMP, 13T (OO) E 2.000 114.286 1,600

001F SAWCUT EXISTING ASPHALT 3,124.000 LF 1.375 4,296 4,296

PERM MATL.
 JOB MATL.

01 SAW CUT EXISTING ASPHALT FOR WIDENINGS

LF IN IN-FT
 NBFR 3,124 5.5 17,182
 SBFR 0 5.5 0

TOTAL 17,182

02 SAWCUT ASPHALT s/ 17,182.000 INF 0.250 4,296

ITEM	DESCRIPTION	QUANTITY	UNIT COST	LABOR	MATERIAL	EQUIPMENT	SUBCONTRACT	TOTAL

AC&GNBFR	MEDICAL PARKWAY - HAND CURB OPT - CONTINUED...							
=====								
002	EARTHWORK	222.000 CY	44.869	2,272		5,817	1,871	9,961

	130.0 MAN-HOURS							
	SUMMARY OF EARTHWORK							
	LOCATION	FILL	CUT					
	NBFR WIDENING	222	317CY					
	ADD 10% SWELL TO FILL	244						
	AMOUNT FROM BORROW	-73	73					
002A	EXCAVATE FOR CURB	1,416.000 LF	0.618	436		438		875

	5/10.0/1--- D - DAYS: 0.50		PROD. RATE: 283.20 LF/HR					
	25.0 MAN-HOURS	56.640 LF PER MAN-HOUR	0.018 MAN-HOURS PER LF					
	01 OPERATOR FOREMAN 2006	L 1.000	0.092	130				
	02 FOREMAN'S PICKUP (HR)	E 1.000	0.026			37		
	03 BLADE OPERATOR 2006	L 1.000	0.068	96				
	04 CAT 140H BLADE (1998)	E 1.000	0.203			287		
	05 GENERAL LABOR 2006	L 2.000	0.098	138				
	06 FRONT END LOADER OPR 06	L 1.000	0.051	72				
	07 POWER BROOM - ROSCO RB48	E 1.000	0.081			114		
002B	EMBANKMENT	222.000 CY	22.347	1,067		3,894		4,961

	5/10.0/1--- D - DAYS: 1.00		PROD. RATE: 22.20 CY/HR					
	60.0 MAN-HOURS	3.700 CY PER MAN-HOUR	0.270 MAN-HOURS PER CY					
	01 OPERATOR FOREMAN 2006	L 1.000	1.170	260				
	02 FOREMAN'S PICKUP (HR)	E 1.000	0.331			73		
	03 10 WHEEL END DUMP, 13T (OO)	E 3.000	5.405			1,200		
	04 GENERAL LABOR 2006	L 1.000	0.623	138				
	05 DOZER OPERATOR 2006	L 1.000	0.835	185				
	06 CAT D6 XL (2003)	E 1.000	3.286			730		
	07 FRONT END LOADER OPR 06	L 1.000	0.649	144				
	08 CAT 966 G LOADER (2004)	E 1.000	3.080			684		

ITEM	DESCRIPTION	QUANTITY	UNIT COST	LABOR	MATERIAL	EQUIPMENT	SUBCONTRACT	TOTAL
AC&GNBFR MEDICAL PARKWAY - HAND CURB OPT - CONTINUED...								
09	ROLLER OPERATOR 2006	L 1.000	0.855	190				
10	HAMM 84" SGL PAD 15 TN - RENT	E 1.000	3.597				798	
11	2.5-4M WATER TRUCK DRIVER	L 1.000	0.676	150				
12	WATER TRUCK - FREIGHTLINER	E 1.000	1.840				408	
002C	REMOVE EXISTING TOPSOIL	93.000 CY	10.123	206			735	941
5/10.0/1--- D - DAYS: 0.50 PROD. RATE: 18.60 CY/HR PERM MATL. JOB MATL.								
12.5 MAN-HOURS 7.440 CY PER MAN-HOUR 0.134 MAN-HOURS PER CY								
FIGURE AT LEAST 5 FEET OF TOPSOIL WILL BE REQUIRED ALONG THE BACKSIDE OF THE WEST CURB								
LENGTH OF CURB AND INLETS		1,500LF						
TOPSOIL PLACEMENT WIDTH		5FT						
TOPSOIL THICKNESS		4IN						
TOPSOIL VOLUME		93CY						
01	OPERATOR FOREMAN 2006	L 0.500	0.698	65				
02	FOREMAN'S PICKUP (HR)	E 0.500	0.198				18	
03	FRONT END LOADER OPR 06	L 1.000	0.775	72				
04	JD 624J IT LOADER (2005)	E 1.000	2.333				217	
05	GENERAL LABOR 2006	L 1.000	0.743	69				
06	EQUIPMENT JOB MOVE	e/ 1.000 EA	500.000				500	
002D	SPREAD TOPSOIL	93.000 CY	6.055	227			336	563
5/10.0/1--- D - DAYS: 0.50 PROD. RATE: 18.60 CY/HR PERM MATL. JOB MATL.								
12.5 MAN-HOURS 7.440 CY PER MAN-HOUR 0.134 MAN-HOURS PER CY								
01	OPERATOR FOREMAN 2006	L 0.500	0.698	65				
02	FOREMAN'S PICKUP (HR)	E 0.500	0.198				18	
03	DOZER OPERATOR 2006	L 1.000	0.997	93				
04	CAT D6H DOZER (1995)	E 1.000	3.419				318	
05	GENERAL LABOR 2006	L 1.000	0.743	69				

 AC&GNBFR MEDICAL PARKWAY - HAND CURB OPT - CONTINUED...

002E FINISH TOPSOIL 833.000 SY 3.146 335 414 1,871 2,621

5/10.0/1--- D - DAYS: 0.50 PROD. RATE: 166.60 SY/HR

20.0 MAN-HOURS 41.650 SY PER MAN-HOUR 0.024 MAN-HOURS PER SY
 01 OPERATOR FOREMAN 2006 L 0.500 0.078 65
 02 FOREMAN'S PICKUP (HR) E 0.500 0.022 18
 03 GENERAL LABOR 2006 L 2.000 0.166 138
 04 THESE LABORERS ARE NEEDED TO PICK OUT LARGE ROOTS AND ROCKS.
 05 JD 624J IT LOADER (2005) E 0.500 0.130 108
 06 FRONT END LOADER OPR 06 L 0.500 0.043 36
 07 BLADE OPERATOR 2006 L 1.000 0.116 96
 08 CAT 140H BLADE (1998) E 1.000 0.345 287
 09 DRILL SEED s/ 1,656.000 SY 0.180 298
 10 EROSION CONTROL BLANKET s/ 1,656.000 SY 0.950 1,573

003 FLEXIBLE BASE (8") 140.000 CY 113.097 3,897 3,160 7,595 1,182 15,834

212.0 MAN-HOURS
 FLEXIBLE BASE NEAT VOLUME 140CY
 FLEXIBLE BASE DEPTH 8IN
 FLEXIBLE BASE NEAT AREA 630SY

THERE IS QUESTION OF HOW MUCH FLEXBASE WILL BE NEEDED BECAUSE HCC PREVIOUSLY PLACED FLEXBASE OUTSIDE THE LIMITS OF THE EXISTING ASPHALT. THE CTRMA AGREE TO PAY FOR THE ACTUAL TONAGE OF FLEXBASE THAT IS NEEDED BASED ON TONAGES ON TRUCK TICKETS. IF FLEXBASE IS REQUIRED IT WILL BE FURNISHED AND INSTALLED AT \$113.10/CY NOT INCLUDING MARKUPS.

003A BASE COURSE MATLS 273.000 TN 15.903 3,160 1,182 4,342

01 BASE COURSES
 FROM TO AREA 8" GRADE 1
 STA STA SY BASE
 NBFR WIDENING 630 140

ITEM	DESCRIPTION	QUANTITY	UNIT COST	LABOR	MATERIAL	EQUIPMENT	SUBCONTRACT	TOTAL
AC&GNBFR MEDICAL PARKWAY - HAND CURB OPT - CONTINUED...								
=====								
	TOTAL			630		140		
02	TOTAL ADDITIONAL QUANTITY	140 CY						
	10" AGGREGATE BASE, GRADE 1	140 CY	1.95TN/CY	273TNS				
	ADD WASTE	30%						
	TOTAL GRADE 1 BASE	355TN						
03	AGG BASE, GRADE 1	p/ 355.000 TN	8.900		3,160			
04	HAUL AGG BASE	s/ 355.000 TN	3.330					1,182
003B	PREP GRADE	630.000 SY	9.384	2,029		3,883		5,912

5/10.0/1---	D - DAYS: 2.00	PROD. RATE: 31.50 SY/HR						
	112.0 MAN-HOURS	5.625 SY PER MAN-HOUR	0.178 MAN-HOURS PER SY					
	INCLUDES ROUGHGRADE AND FINEGRADE PRIOR TO PLACING BASE.							
01	INCLUDES ROUGHGRADE AND FINEGRADE PRIOR TO PLACING BASE.							
02	OPERATOR FOREMAN 2006	L 1.000	0.824	519				
03	FOREMAN'S PICKUP (HR)	E 1.000	0.233					
04	GENERAL LABOR 2006	L 1.000	0.439	277		147		
05	BLADE OPERATOR 2006	L 1.000	0.611	385				
06	CAT 140H BLADE (1998)	E 1.000	1.822					
07	BLADE PRO LASER	E 1.000	0.794			1,148		
08	FRONT END LOADER OPR 06	L 0.100	0.046	29		500		
09	CAT 950 F LOADER (1991)	E 0.100	0.131					
10	ROLLER OPERATOR 2006	L 1.000	0.603	380		82		
11	HAMM 84" SGL PAD 15 TN - RENT	E 1.000	2.535					
12	GENERAL LABOR 2006	L 1.000	0.439	277		1,597		
13	WATER TRUCK DRIVER 2006	L 0.500	0.259	163				
14	WATER TRUCK - FREIGHTLINER	E 0.500	0.648			408		
003C	PLACE & FINISH SELECT BASE	273.000 TN	20.440	1,868		3,712		5,580

5/10.0/1---	D - DAYS: 2.00	PROD. RATE: 13.65 TN/HR						
	100.0 MAN-HOURS	2.730 TN PER MAN-HOUR	0.366 MAN-HOURS PER TN					
01	OPERATOR FOREMAN 2006	L 1.000	1.903	519				
02	FOREMAN'S PICKUP (HR)	E 1.000	0.538					
03	GENERAL LABOR 2006	L 1.000	1.013	277		147		

ITEM	DESCRIPTION	QUANTITY	UNIT COST	LABOR	MATERIAL	EQUIPMENT	SUBCONTRACT	TOTAL
------	-------------	----------	-----------	-------	----------	-----------	-------------	-------

AC&GNBFR MEDICAL PARKWAY - HAND CURB OPT - CONTINUED...

04	BLADE OPERATOR 2006	L	1.000	1.410	385			
05	CAT 140H BLADE (1998)	E	1.000	4.205			1,148	
06	ROLLER OPERATOR 2006	L	1.000	1.391	380			
07	HAMM 84" SGL PAD 15 TN - RENT	E	1.000	5.850				
08	WATER TRUCK DRIVER 2006	L	0.500	0.597	163			1,597
09	WATER TRUCK - FREIGHTLINER	E	0.500	1.496				408
10	FRONT END LOADER OPR 06	L	0.500	0.528	144			
11	CAT 950 F LOADER (1991)	E	0.500	1.509				412
004	AC PAVEMENT		13.000 TN	280.291	1,347	610	1,687	0 3,644
80.0 MAN-HOURS					PERM MATL.	610		
					JOB MATL.			

004A	ASPHALT MATERIALS		13.000 TN	77.692		610	400	1,010
------	-------------------	--	-----------	--------	--	-----	-----	-------

5/10.0/1--- P - DAYS: 1.00 PROD. RATE: 1.30 TN/HR PERM MATL. 610
 JOB MATL.

01 THERE IS A SECTION OF 150 LF ALONG THE NBFR WHICH WILL BE REQUIRED TO BE WIDENED.

RAMING ASPHALT CAN SUPPLY PG76-22 MIX AT \$50/TN FOB GEORGETOWN PLANT

02	AC, TY B BELLY (PG 64-22)	P/	8.000 TN	45.000				
03	AC, TY C BELLY (SURF) (PG 76-22)	P/	5.000 TN	50.000		360		
04	10 WHEEL END DUMP, 13T (OO)	E	1.000	30.769		250		
05	AVERAGE HAUL= 25MILES						400	

LOAD	5.0 MIN							
HAUL	27.3 MIN	SPEED @	55 MPH					
DUMP	130.0 MIN	HAND WORK	CAUSES INEFFICIENT SPREADING OF ASPHALT					
RETURN	27.3 MIN	SPEED @	55 MPH					
TRAFFIC	15.0 MIN							

TOTAL 204.5 MIN

USE 55 MIN/HOUR
 0.3 LOADS/HOUR
 5.0 TN/LOAD

ITEM	DESCRIPTION	QUANTITY	UNIT COST	LABOR	MATERIAL	EQUIPMENT	SUBCONTRACT	TOTAL
------	-------------	----------	-----------	-------	----------	-----------	-------------	-------

AC&GNBFR MEDICAL PARKWAY - HAND CURB OPT - CONTINUED...

1.3 TN/HOUR

004B	HAND PLACE ASPHALT	13.000 TN	202.598	1,347		1,287		2,634
------	--------------------	-----------	---------	-------	--	-------	--	-------

5/10.0/1--- P - DAYS: 1.00 PROD. RATE: 1.30 TN/HR

	80.0 MAN-HOURS	0.163 TN PER MAN-HOUR	6.154 MAN-HOURS PER TN					
01	OPERATOR FOREMAN	L	1.000	24.318	316			
02	FOREMAN'S PICKUP (HR)	E	1.000	5.654		73		
03	FRONT END LOADER OPR 06	L	1.000	11.085	144			
04	CAT 950 F LOADER (1991)	E	1.000	31.685		412		
05	ROLLER OPERATOR 2006	L	1.000	14.605	190			
06	DYNPAC 66" SMOOTH 5 TN - RENT	E	1.000	44.008		572		
07	GENERAL LABOR 2006	L	4.000	42.545	553			
08	FRONT END LOADER OPR 06	L	1.000	11.085	144			
09	POWER BROOM - ROSCO RB48	E	1.000	17.615		229		

005	CURB AND GUTTER	2,852.000 LF	15.500			44,206		44,206
-----	-----------------	--------------	--------	--	--	--------	--	--------

 THIS OPTION IS TO NEAT SAW CUT ASPHALT AND HAND POUR THE CURB AND GUTTER WITH THE EDGE OF ASPHALT SERVING AS A EDGE FORM.

005A	CURB AND GUTTER (TY II)	2,852.000 LF	15.500			44,206		44,206
------	-------------------------	--------------	--------	--	--	--------	--	--------

01	C&G TY II - AARON HAND	s/	2,852.000 LF	15.500		44,206		
----	------------------------	----	--------------	--------	--	--------	--	--

006	DRAINAGE	1.000 LS	44,075.000			44,075		44,075
-----	----------	----------	------------	--	--	--------	--	--------

006A	TY C 5' OPEN BACK CURB INLET	9.000 EA	2,550.000			22,950		22,950
------	------------------------------	----------	-----------	--	--	--------	--	--------

 PERM MATL.
 JOB MATL.

ITEM	DESCRIPTION	QUANTITY	UNIT COST	LABOR	MATERIAL	EQUIPMENT	SUBCONTRACT	TOTAL
AC&GNBFR MEDICAL PARKWAY - HAND CURB OPT - CONTINUED...								
01	OPEN BACK CURB INLET - 5' s/	9.000 EA	2,550.000					22,950
006B	TY C 10' OPEN BACK CURB INLET	5.000 EA	3,375.000					16,875
								16,875
01	OPEN BACK CURB INLET - 10' s/	5.000 EA	3,375.000					16,875
006C	TY C 15' OPEN BACK CURB INLET	1.000 EA	4,250.000					4,250
								4,250
01	OPEN BACK CURB INLET - 15' s/	1.000 EA	4,250.000					4,250
007	STRIPING	1.000 LS	3,905.350					3,905
								3,905

007A	REFL PAV MRK TY I (W) 4" BRK	627.000 LF	0.310					194
								194
01	REFL PVMK TY I (W) (4") (BRK) S	627.000 LF	0.310					194
007B	REFL PAV MRK TY I (W) 4" SLD	181.000 LF	0.280					51
								51
01	REFL PVMK TY I (W) (4") (SLD) S	181.000 LF	0.280					51
007C	REFL PAV MRK TY I (W) 8" SLD	181.000 LF	0.600					109
								109
01	REFL PVMK TY I (Y) (8") (SLD) S	181.000 LF	0.600					109
								<PLUG>

ITEM	DESCRIPTION	QUANTITY	UNIT COST	LABOR	MATERIAL	EQUIPMENT	SUBCONTRACT	TOTAL
AC&GNBFR MEDICAL PARKWAY - HAND CURB OPT - CONTINUED...								
007D	REFL PAV MRK TY I (Y) 4" SLD	275.000 LF	0.300				83	83
	01 REFL PVMK TY I (Y) (4") (SLD)	S 275.000 LF	0.300		PERM MATL. JOB MATL.		83	
007E	REFL PAV MRK TY II-C-R	31.000 EA	3.950				122	122
	01 REFL PAV MRK TY II-C-R	s/ 31.000 EA	3.950		PERM MATL. JOB MATL.		122	
007F	ELIM EXT PAV MRK (4"0	3,055.000 LF	0.850				2,597	2,597
	01 ELIM PVMK & MRKR (4")	s/ 3,055.000 LF	0.850		PERM MATL. JOB MATL.		2,597	
007G	STRIPING MOB ALLOWANCE	1.000 LS	750.000				750	750
	01 STRIPING MOB ALLOWANCE	s/ 1.000 LS	750.000		PERM MATL. JOB MATL.		750	
008	SIGNING	1.000 LS	5,942.000				5,942	5,942

					PERM MATL. JOB MATL.			
008A	SIGNING	1.000 LS	5,942.000				5,942	5,942
	01 SCH 80 SA T - SIGN ASSEMBLY	s/ 8.000 EA	624.000		PERM MATL. JOB MATL.		4,992	
	02 SCH 80 SA T - MEDICAL PKWY SIGN	s/ 1.000 EA	675.000				675	
	03 REMOVE SMALL SIGN	s/ 1.000 EA	275.000				275	

ITEM	DESCRIPTION	QUANTITY	UNIT COST	LABOR	MATERIAL	EQUIPMENT	SUBCONTRACT	TOTAL
AC&GNBFR MEDICAL PARKWAY - HAND CURB OPT - CONTINUED...								
009	TRAFFIC CONTROL	1.000 LS	17,150.000					17,150
							17,150	17,150
***** PERM MATL. *****								
***** JOB MATL. *****								
009A	TRAFFIC MOT - UNITED RENTALS	34.000 DAY	504.412					17,150
								17,150
5/10.0/1--- D - DAYS: 34.00 PROD. RATE: 0.10 DAY/HR								
***** PERM MATL. *****								
***** JOB MATL. *****								
01 CTRMA WILL PAY ACTUAL QTY OF LANE CLOSURES AND MESSAGE BOARD DAYS								
02	SINGLE LANE CLOSURE - UR	s/ 34.000 DAY	350.000					11,900
03	MESSAGE BOARD - UR	s/ 14.000 DAY	375.000					5,250
010	INCIDENTALS	1.000 LS	10,517.902	3,224	200			7,094
								10,518
***** PERM MATL. *****								
***** JOB MATL. *****								
120.0 MAN-HOURS								
010A	SURVEY PERSONNEL	0.200 MO	14,060.600	2,612	200			2,812
								2,812
5/10.0/1--- D - DAYS: 4.00								
***** PERM MATL. *****								
***** JOB MATL. *****								
120.0 MAN-HOURS 0.002 MO PER MAN-HOUR 600.000 MAN-HOURS PER MO								
01	SURVEY CHIEF	G 0.200 MO	5,200.000	1,040				
02	INSTRUMENT MAN	L 1.000	3,333.000	667				
03	CHAINMAN	L 2.000	4,527.600	906				
04	*SURV-SURVEY SUPPLIES	j/ 0.200 MO	1,000.000		200			
010B	2007 LABOR ESCALATION	5.000 %	122.350	612				612
								612
***** PERM MATL. *****								
***** JOB MATL. *****								
01	2007 LABOR ESCALATION	1/ 12,235.000 \$	0.050	612				
010C	CONSTRUCTION QA	1.000 LS	7,094.032					7,094
								7,094
***** PERM MATL. *****								
***** JOB MATL. *****								
01	RODRIGUEZ QA	s/ 161,228.000 \$	0.044					7,094

305 HCD TEXAS REGIONAL OFFIC GRANITE CONSTRUCTION INCORPORATED

BID BODY

BID INTERACTIVE DEVELOPMENT SYSTEM 2 (V 4.73)

VER. #1.000

PAGE: 14

BID DATE: 09/30/04

JOB 183A1205 : US 183A - NORTH TIE-IN ALTERNATE

F ADD. #

RUN DATE: 07/23/07

RUN TIME: 14:10

ITEM	DESCRIPTION	QUANTITY	UNIT COST	LABOR	MATERIAL	EQUIPMENT	SUBCONTRACT	TOTAL

AC&GNBFR	MEDICAL PARKWAY - HAND CURB OPT - CONTINUED...							
=====								

02 AT BID TIME RODRIGUEZ QA TESTING WAS FIGURED TO BE 4.37% OF THE DIRECT CONSTRUCTION DOLLARS.

**Exhibit CO.24.3
Preliminary Design Plan Sheet**



2018-07
 KRIS Z. KEITH
 93775
 PROFESSIONAL ENGINEER
 STATE OF TEXAS

NO.	DATE	DESCRIPTION
1	07/11/18	ISSUED FOR PERMITS, 2018
2	07/11/18	ISSUED FOR PERMITS, 2018
3	07/11/18	ISSUED FOR PERMITS, 2018
4	07/11/18	ISSUED FOR PERMITS, 2018

183A TURNPIKE PROJECT
 ROADWAY TYPICAL SECTIONS
 NB FRONTAGE RD 3

HORIZONTALS: NTS
 VERTICALS: NTS
 DRAWING: 18TS06-A
 SHEET 7 OF 14 SHEETS

STATE OF TEXAS
 CENTRAL TEXAS REGIONAL
 MOBILITY AUTHORITY
 I-83A TURNPIKE PROJECT
 INTERIM DESIGN
 © 2007

HNTB
 INCORPORATED
 Highway and Traffic Division

NO.	DATE	DESCRIPTION
1	07/11/18	ISSUED FOR PERMITS, 2018
2	07/11/18	ISSUED FOR PERMITS, 2018
3	07/11/18	ISSUED FOR PERMITS, 2018
4	07/11/18	ISSUED FOR PERMITS, 2018

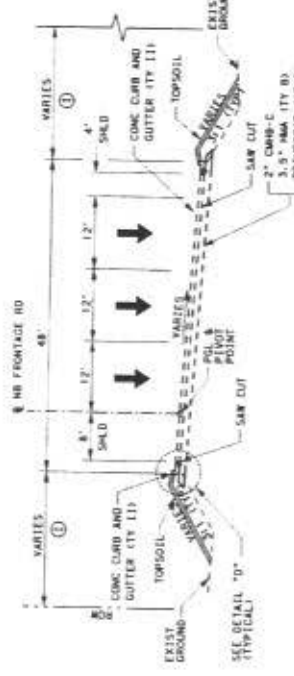

PROPOSED NB FRONTAGE RD
 STA 1603+00.00 TO STA 1605+27.25

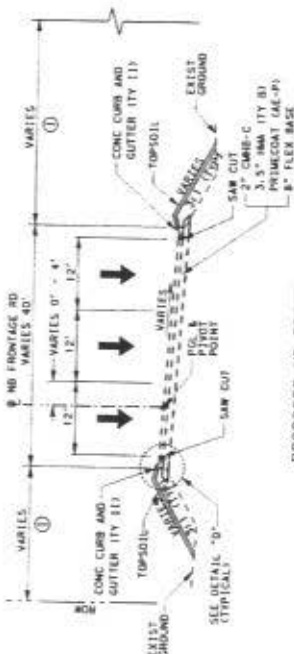

PROPOSED NB FRONTAGE RD
 STA 1590+40.00 TO STA 1599+87.64

- LEGEND:**
- ① 5.5" HMA — 2" CMH-C PG (SEE GENERAL NOTES SHEETS)
 - ② 7.5" HMA — 3.5" HMA (TY B)
 - ③ 10" FLEXIBLE BASE, ITEM 249, TY A, OR 1 OR GR 1 (MOD) — 2" CMH-C PG (SEE GENERAL NOTES SHEETS)
 - ④ 8" FLEXIBLE BASE, ITEM 247, TY A — 2" CMH-C PG (SEE GENERAL NOTES SHEETS)
 - ⑤ 4" TOPSOIL — 2" CMH-C PG (SEE GENERAL NOTES SHEETS)
 - ⑥ 10" FLEXIBLE BASE, ITEM 249, TY A, OR 1 OR GR 1 (MOD) — 2" CMH-C PG (SEE GENERAL NOTES SHEETS)
 - ⑦ 8" FLEXIBLE BASE, ITEM 247, TY A — 2" CMH-C PG (SEE GENERAL NOTES SHEETS)

- NOTES:**
1. SEE ROADWAY CONSTRUCTION PLAN SHEETS FOR CURB AND GUTTER DETAILS.
 2. SEE PLAN SHEETS FOR CROSS-SLOPE DETAIL.
 3. SEE PLAN SHEETS FOR RETAINING WALL AND TRAFFIC NAIL LOCATIONS AND BRIDGE LIMITS.
 4. SEE PLAN SHEETS FOR CROSS-SLOPE DETAIL.

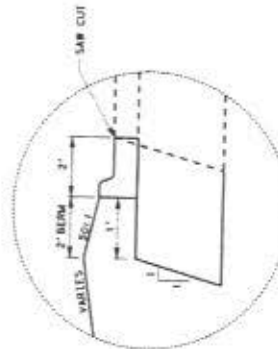

DETAIL "D"



Kris Z. Keith
 6/13/07
 STATE OF TEXAS
 PROFESSIONAL ENGINEER
 LICENSE NO. 93753

NO.	DATE	DESCRIPTION	BY	CHKD.
1	06/13/07	ISSUED FOR PERMIT	KZK	WLL

183A TURNPIKE PROJECT
 ROADWAY CONSTRUCTION PLAN
 STA 491+00 TO STA 591+00
 HORIZONTAL 1" = 100'
 DRAWING: RPL33
 SHEET 13 OF 62 SHEETS

STATE OF TEXAS
 CENTRAL TEXAS REGIONAL
 MOBILITY AUTHORITY
 IMA TURNPIKE PROJECT
 INTERIM DESIGN
 © 2007

HNTB		183A Turnpike Interim Design	
PROJECT NO.	183A	DATE	06/13/07
PROJECT NAME	183A TURNPIKE PROJECT	SCALE	AS SHOWN
DESIGNED BY	WILLIAMSON	CHECKED BY	WILLIAMSON
DRAWN BY	WILLIAMSON	APPROVED BY	WILLIAMSON

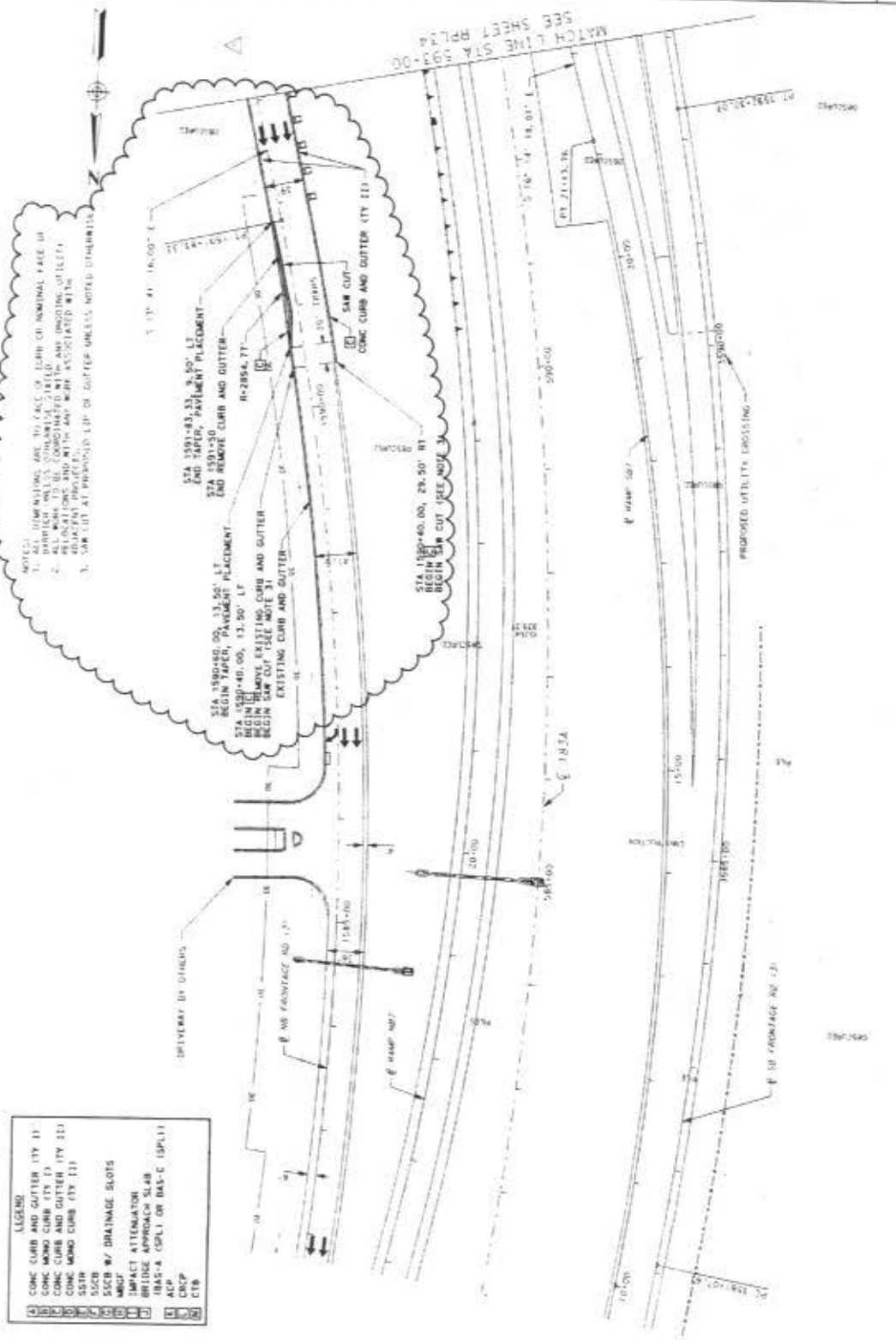

LEGEND

	CONC CURB AND GUTTER (TY 1)
	CONC MONO CURB (TY 1)
	CONC CURB AND GUTTER (TY 2)
	CONC MONO CURB (TY 2)
	S&SB
	S&CB w/ DRAINAGE SLOTS
	IMPACT ATTENUATOR
	BRIDGE APPROACH SLAB
	18AS-A, CSPLI OR BAS-C (SPLI)
	ACP
	C&P
	C&B

MATCH LINE STA 491+00
 SEE SHEET RPL34

PROPOSED UTILITY CROSSING

DATE:



May 2, 2007
 0-13-07
 NOTE: THIS SEAL IS ONLY VALID FOR THE PROJECT FOR WHICH IT IS ISSUED.

NO.	DATE	DESCRIPTION	BY	CHKD.
1	05/02/07	ISSUED FOR CONSTRUCTION		

183A TURNPIKE PROJECT
 ROADWAY CONSTRUCTION R/L/RT
 STA 593+00 TO STA 603+00

HORIZONTALS: 1" = 100'
 DRAWING: RPL34
 SHEET 34 OF 62 SHEETS

STATE OF TEXAS
 CENTRAL TEXAS REGIONAL
 MOBILITY AUTHORITY
 IGA TURNPIKE PROJECT
 INTERIM DESIGN
 © 2007

MNTB THE ARTS COMPANY
 INTERIM DESIGN

PROJECT NO.	183A
DATE	05/02/07
SCALE	AS SHOWN
DRAWN BY	MS
CHECKED BY	MS
DATE	05/02/07
PROJECT NO.	183A
DATE	05/02/07
SCALE	AS SHOWN
DRAWN BY	MS
CHECKED BY	MS
DATE	05/02/07

NOTE 3:
 1. ALL DIMENSIONS ARE TO FACE OF CURB OR NOMINAL FACE OF
 STRUCTURE UNLESS OTHERWISE STATED.
 2. ALL DIMENSIONS ARE TO FACE OF CURB OR NOMINAL FACE OF
 STRUCTURE UNLESS OTHERWISE STATED.
 3. ALL DIMENSIONS ARE TO FACE OF CURB OR NOMINAL FACE OF
 STRUCTURE UNLESS OTHERWISE STATED.
 4. ALL DIMENSIONS ARE TO FACE OF CURB OR NOMINAL FACE OF
 STRUCTURE UNLESS OTHERWISE STATED.
 5. SAW CUT AT PROPOSED TIP OF GUTTER UNLESS OTHERWISE NOTED.

LEGEND

- CONC CURB AND GUTTER (TY 3)
- CONC WARD CURB (TY 3)
- CONC WARD GUTTER (TY 11)
- CONC WARD CURB (TY 11)
- SSCB
- SSCB W/ DRAINAGE SLOTS
- IMPACT ATTENUATOR
- BRIDGE APPROACH SLAB (BAS-A (SPL) OR BAS-C (SPL))
- MBSP
- CUF
- CTB

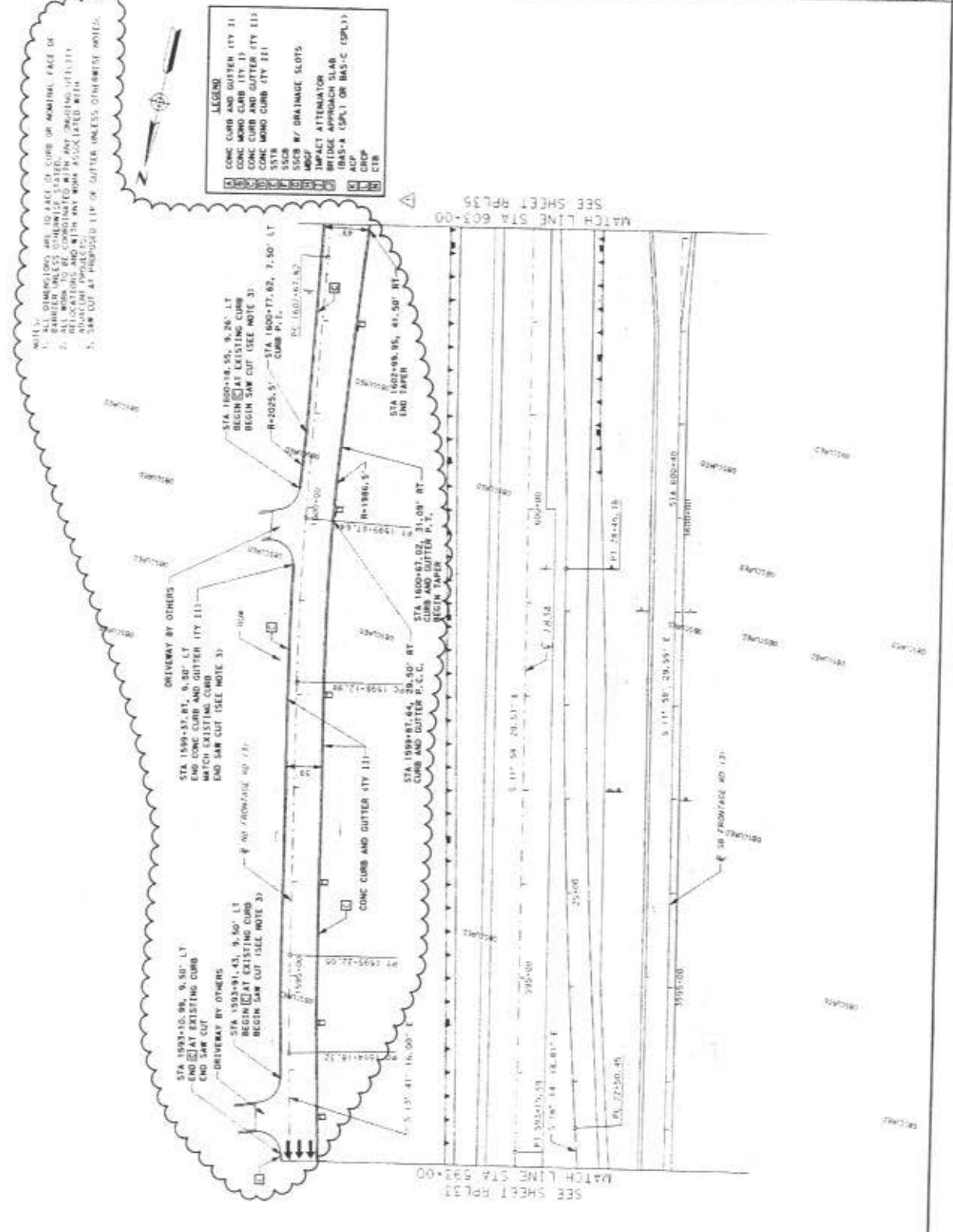

MATCH LINE STA 593+00
 SEE SHEET RPL33

MATCH LINE STA 603+00
 SEE SHEET RPL35



Nov 2 2020 613-07
 NOT FOR SEALS, STAMPS, APPLICATIONS, AND NOT FOR SIGNATURE PURPOSES

NO.	DATE	DESCRIPTION
1	11/2/20	ISSUED FOR PERMITS
2	11/2/20	REVISED PER COMMENTS
3	11/2/20	REVISED PER COMMENTS
4	11/2/20	REVISED PER COMMENTS
5	11/2/20	REVISED PER COMMENTS
6	11/2/20	REVISED PER COMMENTS
7	11/2/20	REVISED PER COMMENTS
8	11/2/20	REVISED PER COMMENTS
9	11/2/20	REVISED PER COMMENTS
10	11/2/20	REVISED PER COMMENTS

183A TURNPIKE PROJECT
 ROADWAY CONSTRUCTION PLAN
 STA 603+00 TO STA 615+00

HORIZONTAL: 1" = 100'
 DRAWING: RPL 35
 SHEET 25 OF 63 SHEETS

STATE OF TEXAS
 CENTRAL TEXAS REGIONAL
 MOBILITY AUTHORITY
 IBA TURNPIKE PROJECT
 INTERIM DESIGN
 © 2007

HNTB
 THE HNTB COMPANY
 1500 WEST 13TH STREET
 DALLAS, TEXAS 75202

PROJECT NO.	183A
SHEET NO.	25
TOTAL SHEETS	63
DATE	NOV 2007 (241)
DESIGNED BY	TEJAS KUSUMBI
CHECKED BY	TEJAS KUSUMBI
DRAWN BY	TEJAS KUSUMBI
SCALE	AS SHOWN

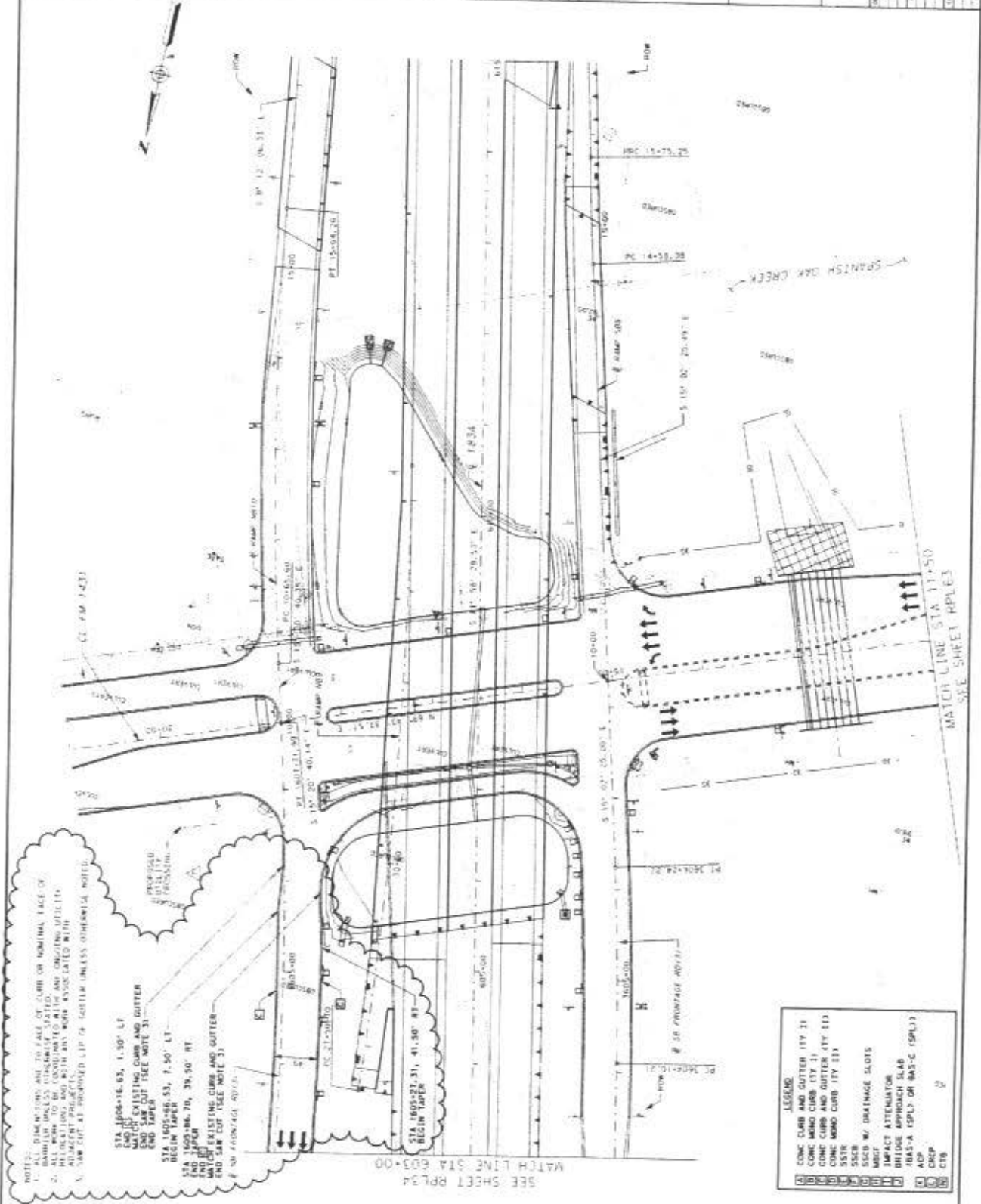

NOTES:
 1. DIMENSIONS ARE TO FACE OF CURB OR NOMINAL EDGE OF ROADWAY UNLESS OTHERWISE NOTED.
 2. ALL WORK TO BE CONFORMED WITH ANY APPLICABLE SPECIFICATIONS AND WITH ANY WORK ASSOCIATED WITH THE PROJECT.
 3. SEE CUT AT APPROVED LIP TO GUTTER UNLESS OTHERWISE NOTED.

STA 1808+16.63, 1+30' LT
 END OF EXISTING CURB AND GUTTER
 MATCH LINE SEE NOTE 3
 END TAPER

STA 1805+46.53, 1+30' LT
 BEGIN TAPER
 END OF EXISTING CURB AND GUTTER
 MATCH LINE SEE NOTE 3
 END TAPER

STA 1803+86.70, 39+30' RT
 END OF EXISTING CURB AND GUTTER
 MATCH LINE SEE NOTE 3
 END TAPER

STA 1803+21.31, 41+30' RT
 BEGIN TAPER

LEGEND

[Symbol]	CONC CURB AND GUTTER (TY 1)
[Symbol]	CONC MHO CURB (TY 1)
[Symbol]	CONC CURB AND GUTTER (TY 1)
[Symbol]	CONC MHO CURB (TY 1)
[Symbol]	SSSB
[Symbol]	SSSB W/ DRAINAGE SLOTS
[Symbol]	MIST
[Symbol]	IMPACT ATTENUATOR
[Symbol]	BRIDGE APPROACH SLAB
[Symbol]	IBAS-A (SPL) OR IBAS-C (SPL)
[Symbol]	ADP
[Symbol]	CRP
[Symbol]	CTB

MATCH LINE STA 615+00
 SEE SHEET RPL 36



KRIS Z. KEITH
 LICENSED PROFESSIONAL ENGINEER
 93713
 STATE OF TEXAS
 EXPIRES 06/30/2007
 613-07

NO.	DATE	DESCRIPTION	BY	CHECKED
1	11/15/06	ISSUED FOR CONSTRUCTION	KZK	...
2	11/15/06	ISSUED FOR CONSTRUCTION	KZK	...
3	11/15/06	ISSUED FOR CONSTRUCTION	KZK	...
4	11/15/06	ISSUED FOR CONSTRUCTION	KZK	...
5	11/15/06	ISSUED FOR CONSTRUCTION	KZK	...

183A TURNPIKE PROJECT

DRAINAGE PLAN

STA 581+00 TO STA 593+00

HORIZONTAL: 1" = 100'

DRAWING: DPL 33

SHEET 36 OF 65 SHEETS

STATE OF TEXAS
 CENTRAL TEXAS REGIONAL
 MOBILITY AUTHORITY
 IMA TURNPIKE PROJECT
 INTERIM DESIGN
 © 2007



NO.	DATE	DESCRIPTION	BY	CHECKED
1	11/15/06	ISSUED FOR CONSTRUCTION	KZK	...
2	11/15/06	ISSUED FOR CONSTRUCTION	KZK	...
3	11/15/06	ISSUED FOR CONSTRUCTION	KZK	...
4	11/15/06	ISSUED FOR CONSTRUCTION	KZK	...
5	11/15/06	ISSUED FOR CONSTRUCTION	KZK	...

OPEN BACK CURB INLET SUMMARY TABLE

INLET ID	STA	OFFSET TO FOC	TC	LENGTH	CURB	SAFETY PIPE
MP-1	1582+00	20'-00"	81"	5'-0"	TY	18"
MP-2	1582+75	20'-00"	81"	5'-0"	TY	18"
MP-3	1583+00	20'-00"	81"	5'-0"	TY	18"
MP-4	1583+75	20'-00"	81"	5'-0"	TY	18"
MP-5	1584+00	20'-00"	81"	5'-0"	TY	18"

NOTE: TC'S TO BE SET AS PER EXISTING PAVEMENT CROSS-SLOPE WIDENING.

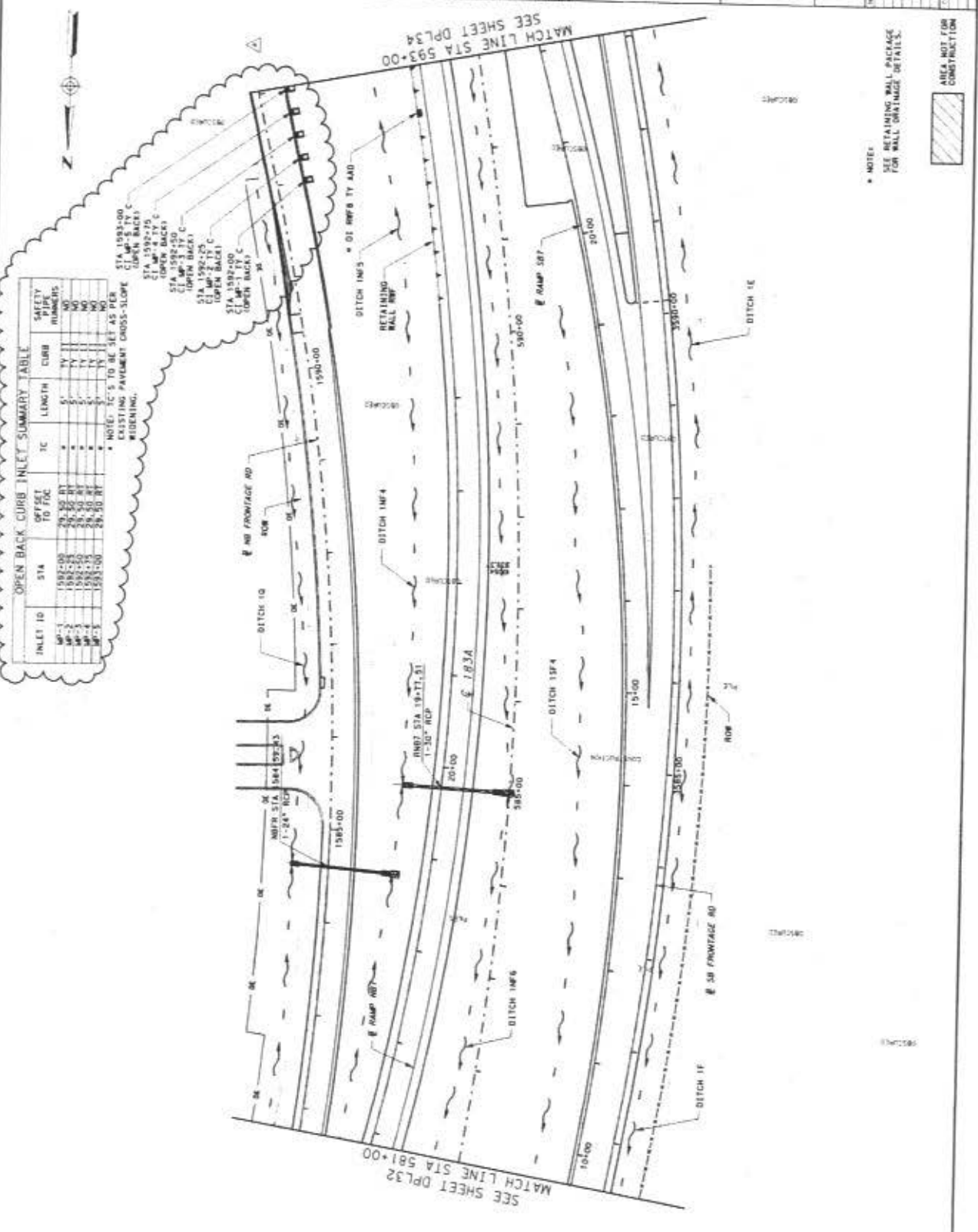

NOTE: SEE RETAINING WALL PACKAGE FOR WALL DRAINAGE DETAILS.

AREA NOT FOR CONSTRUCTION



Kris Z. Keith 6-13-07
 PROFESSIONAL ENGINEER
 LICENSE NO. 93763
 STATE OF TEXAS

NO.	DATE	DESCRIPTION	BY	CHECKED
1	06/13/07	ISSUED FOR PERMITS	KZK	
2	06/13/07	ISSUED FOR PERMITS	KZK	
3	06/13/07	ISSUED FOR PERMITS	KZK	
4	06/13/07	ISSUED FOR PERMITS	KZK	
5	06/13/07	ISSUED FOR PERMITS	KZK	
6	06/13/07	ISSUED FOR PERMITS	KZK	
7	06/13/07	ISSUED FOR PERMITS	KZK	
8	06/13/07	ISSUED FOR PERMITS	KZK	
9	06/13/07	ISSUED FOR PERMITS	KZK	
10	06/13/07	ISSUED FOR PERMITS	KZK	

183A TURNPIKE PROJECT
 DRAINAGE PLAN

STA 593+00 TO STA 603+00

HORIZONTAL: 1" = 100'

DRAWING: DPL3.4
 SHEET 37 OF 65 SHEETS

STATE OF TEXAS
 CENTRAL TEXAS REGIONAL
 MOBILITY AUTHORITY
 183A TURNPIKE PROJECT
 INTERIM DESIGN
 © 2007

HNTB
 THE HNTB COMPANY
 1800 WEST WASHINGTON

NO.	DATE	DESCRIPTION	BY	CHECKED
1	06/13/07	ISSUED FOR PERMITS	KZK	
2	06/13/07	ISSUED FOR PERMITS	KZK	
3	06/13/07	ISSUED FOR PERMITS	KZK	
4	06/13/07	ISSUED FOR PERMITS	KZK	
5	06/13/07	ISSUED FOR PERMITS	KZK	
6	06/13/07	ISSUED FOR PERMITS	KZK	
7	06/13/07	ISSUED FOR PERMITS	KZK	
8	06/13/07	ISSUED FOR PERMITS	KZK	
9	06/13/07	ISSUED FOR PERMITS	KZK	
10	06/13/07	ISSUED FOR PERMITS	KZK	



OPEN BACK CURB INLET SUMMARY TABLE

INLET ID	STA	OFFSET TO FDC	TC	LENGTH	CMR	SAFETY PIPE RUNNERS
183A-1	1593+50	39.50 RT	5'	5'	TY	NO
183A-2	1594+50	39.50 RT	5'	5'	TY	NO
183A-3	1595+50	39.50 RT	5'	5'	TY	NO
183A-4	1596+50	39.50 RT	5'	5'	TY	NO
183A-5	1597+50	39.50 RT	5'	5'	TY	NO
183A-6	1598+50	39.50 RT	5'	5'	TY	NO
183A-7	1599+50	39.50 RT	5'	5'	TY	NO
183A-8	1600+50	39.50 RT	5'	5'	TY	NO
183A-9	1601+50	39.50 RT	5'	5'	TY	NO
183A-10	1602+50	39.50 RT	5'	5'	TY	NO

NOTE: TC'S TO BE SET AS PER EXISTING PAVEMENT CROSS-SLOPE WIDENING.

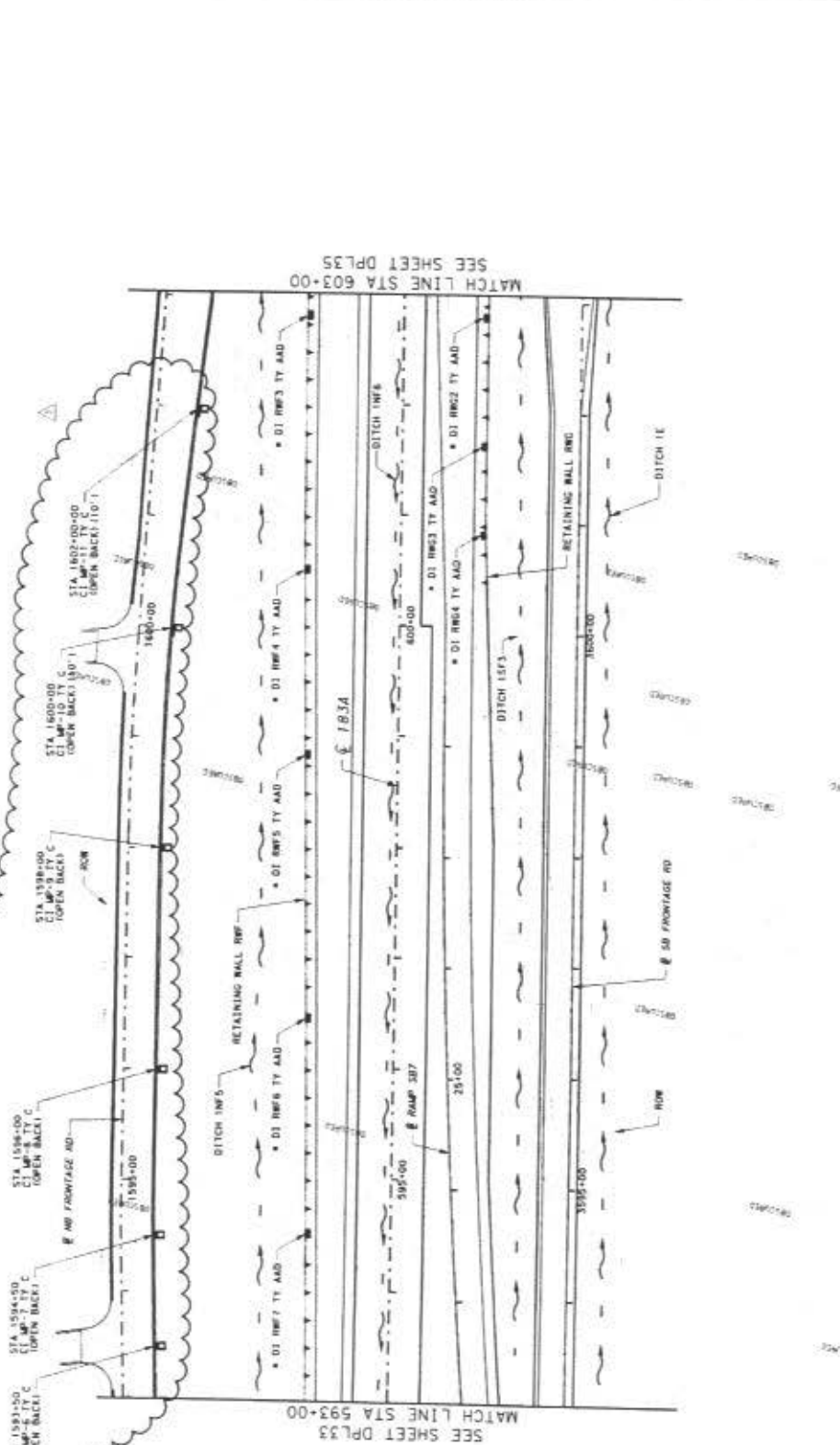

NOTE:
 SEE RETAINING WALL PACKAGE FOR WALL DRAINAGE DETAILS.



MATCH LINE STA 593+00
 SEE SHEET DPL3.3

MATCH LINE STA 603+00
 SEE SHEET DPL3.5



Kris Z. Keith 6-15-07
 NOTES: THIS SEAL IS ONLY VALID IF USED FOR THE PROJECT, DATE AND NOT FOR ANY OTHER PROJECT.

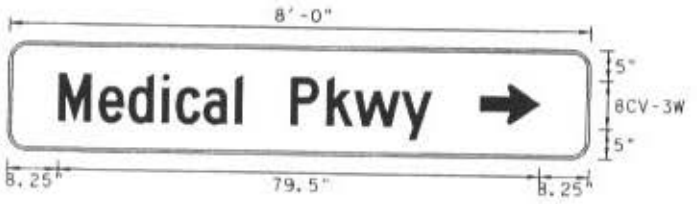
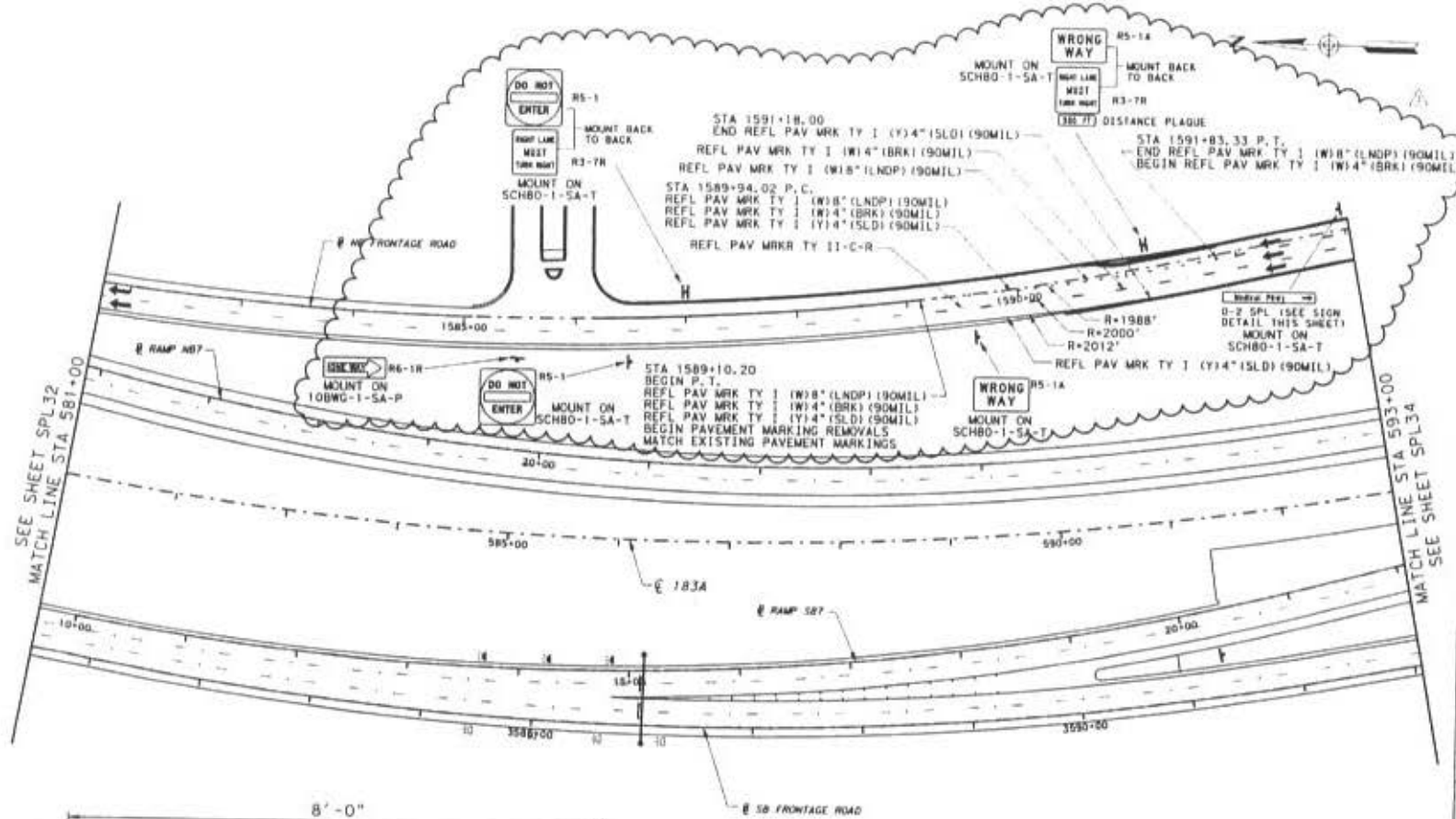

BORDER
 R=1.5"
 TH=0.5"
 BACKGROUND COLOR = GREEN
 BORDER COLOR = WHITE
 TEXT COLOR = WHITE

NO.	DATE	REVISION	APPROVED
1	06/15/07	REVISED PER COMMENTS	KZ
2	06/21/07	REVISED PER COMMENTS	KZ
3	07/02/07	REVISED PER COMMENTS	KZ
4	07/10/07	REVISED PER COMMENTS	KZ
5	07/17/07	REVISED PER COMMENTS	KZ
6	07/24/07	REVISED PER COMMENTS	KZ
7	08/01/07	REVISED PER COMMENTS	KZ
8	08/08/07	REVISED PER COMMENTS	KZ
9	08/15/07	REVISED PER COMMENTS	KZ
10	08/22/07	REVISED PER COMMENTS	KZ
11	08/29/07	REVISED PER COMMENTS	KZ
12	09/05/07	REVISED PER COMMENTS	KZ
13	09/12/07	REVISED PER COMMENTS	KZ
14	09/19/07	REVISED PER COMMENTS	KZ
15	09/26/07	REVISED PER COMMENTS	KZ
16	10/03/07	REVISED PER COMMENTS	KZ
17	10/10/07	REVISED PER COMMENTS	KZ
18	10/17/07	REVISED PER COMMENTS	KZ
19	10/24/07	REVISED PER COMMENTS	KZ
20	10/31/07	REVISED PER COMMENTS	KZ

183A TURNPIKE PROJECT
 SIGNING AND STRIPING PLAN
 STA 581+00 TO STA 593+00

HORIZONTAL: 1" = 100'

DRAWING: SPL 33
 SHEET 03 OF 19 SHEETS

STATE OF TEXAS
 CENTRAL TEXAS REGIONAL
 MOBILITY AUTHORITY
 183A TURNPIKE PROJECT
 INTERIM DESIGN
 © 2007



DATE	BY	CHKD BY	APP'D BY	REVISED BY
06/15/07	KZ			
06/21/07	KZ			
07/02/07	KZ			
07/10/07	KZ			
07/17/07	KZ			
07/24/07	KZ			
08/01/07	KZ			
08/08/07	KZ			
08/15/07	KZ			
08/22/07	KZ			
08/29/07	KZ			
09/05/07	KZ			
09/12/07	KZ			
09/19/07	KZ			
09/26/07	KZ			
10/03/07	KZ			
10/10/07	KZ			
10/17/07	KZ			
10/24/07	KZ			
10/31/07	KZ			
11/07/07	KZ			
11/14/07	KZ			
11/21/07	KZ			
11/28/07	KZ			
12/05/07	KZ			
12/12/07	KZ			
12/19/07	KZ			
12/26/07	KZ			

183A TURNPIKE PROJECT, STA 581+00 TO STA 593+00, SHEET 03 OF 19 SHEETS, DATE 06/15/07, DRAWN BY KZ, CHECKED BY [blank], APPROVED BY [blank]



K. Z. KEITH
 6-13-07
 PROFESSIONAL ENGINEER
 LICENSE NO. 93753-D
 STATE OF TEXAS

NO.	DATE	DESCRIPTION
1	06/13/07	ISSUED FOR PERMITS
2	06/13/07	ISSUED FOR PERMITS
3	06/13/07	ISSUED FOR PERMITS
4	06/13/07	ISSUED FOR PERMITS
5	06/13/07	ISSUED FOR PERMITS
6	06/13/07	ISSUED FOR PERMITS
7	06/13/07	ISSUED FOR PERMITS
8	06/13/07	ISSUED FOR PERMITS
9	06/13/07	ISSUED FOR PERMITS
10	06/13/07	ISSUED FOR PERMITS

183A TURNPIKE PROJECT
 SIGNING AND STRIPING PLAN
 STA 593+00 TO STA 603+00

HORIZONTAL: 1" = 100'
 DRAWING: SPL34
 SHEET 2 OF 2 SHEETS

STATE OF TEXAS
 CENTRAL TEXAS REGIONAL
 MOBILITY AUTHORITY
 IBA TURNPIKE PROJECT
 INTERIM DESIGN
 © 2007

HNTB
 THE HNTB COMPANY
 10000 WEST 100TH AVENUE
 GREENWOOD VILLAGE, CO 80120

PROJECT NO.	183A
DISTRICT	001
CONTRACT NO.	001
DATE	06/13/07
SCALE	AS SHOWN
DESIGNED BY	WILLIAMSON
CHECKED BY	WILLIAMSON
DATE	06/13/07
PROJECT NO.	183A
DISTRICT	001
CONTRACT NO.	001
DATE	06/13/07
SCALE	AS SHOWN
DESIGNED BY	WILLIAMSON
CHECKED BY	WILLIAMSON
DATE	06/13/07

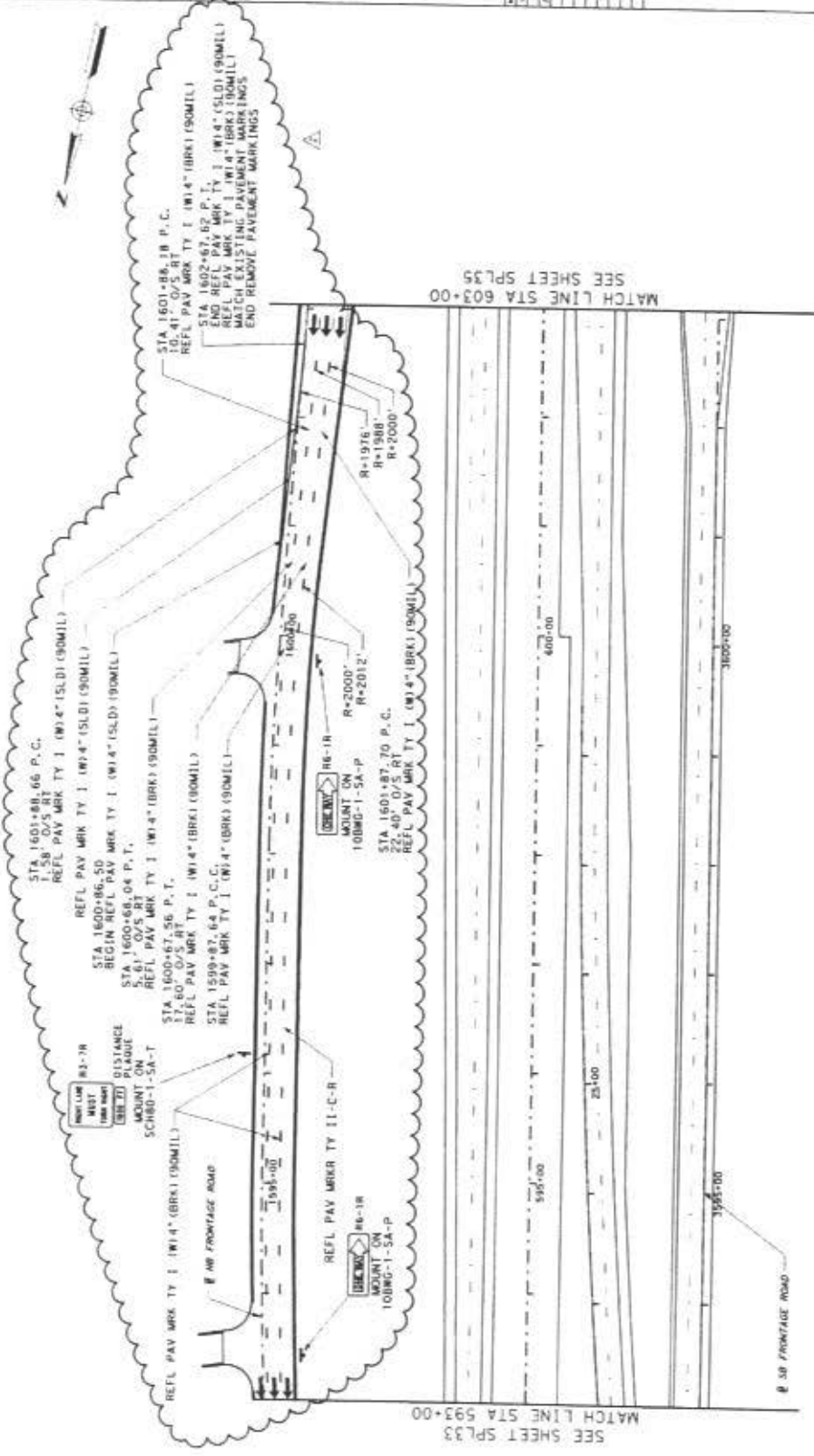

SEE SHEET SPL33
 MATCH LINE STA 593+00

SEE SHEET SPL35
 MATCH LINE STA 603+00



Kris Z. Keith
 643-07
 1501 W. 15th Street, Suite 100
 Fort Worth, Texas 76104
 (817) 336-1111

NO.	DATE	DESCRIPTION	BY	CHKD.
1	08/14/07	ISSUED FOR PERMITS	AK	AK
2	08/14/07	ISSUED FOR PERMITS	AK	AK
3	08/14/07	ISSUED FOR PERMITS	AK	AK
4	08/14/07	ISSUED FOR PERMITS	AK	AK
5	08/14/07	ISSUED FOR PERMITS	AK	AK
6	08/14/07	ISSUED FOR PERMITS	AK	AK
7	08/14/07	ISSUED FOR PERMITS	AK	AK
8	08/14/07	ISSUED FOR PERMITS	AK	AK
9	08/14/07	ISSUED FOR PERMITS	AK	AK
10	08/14/07	ISSUED FOR PERMITS	AK	AK

183A TURNPIKE PROJECT
 SIGNING AND STRIPING PLAN
 STA 603+00 TO STA 615+00

HORIZONTAL: 1" = 100'
 DRAWING: SPL35
 SHEET 05 OF 19 SHEETS

STATE OF TEXAS
 CENTRAL TEXAS REGIONAL
 MOBILITY AUTHORITY
 I-35A TURNPIKE PROJECT
 INTERIM DESIGN
 © 2007



NO.	DATE	DESCRIPTION	BY	CHKD.
1	08/14/07	ISSUED FOR PERMITS	AK	AK
2	08/14/07	ISSUED FOR PERMITS	AK	AK
3	08/14/07	ISSUED FOR PERMITS	AK	AK
4	08/14/07	ISSUED FOR PERMITS	AK	AK
5	08/14/07	ISSUED FOR PERMITS	AK	AK
6	08/14/07	ISSUED FOR PERMITS	AK	AK
7	08/14/07	ISSUED FOR PERMITS	AK	AK
8	08/14/07	ISSUED FOR PERMITS	AK	AK
9	08/14/07	ISSUED FOR PERMITS	AK	AK
10	08/14/07	ISSUED FOR PERMITS	AK	AK

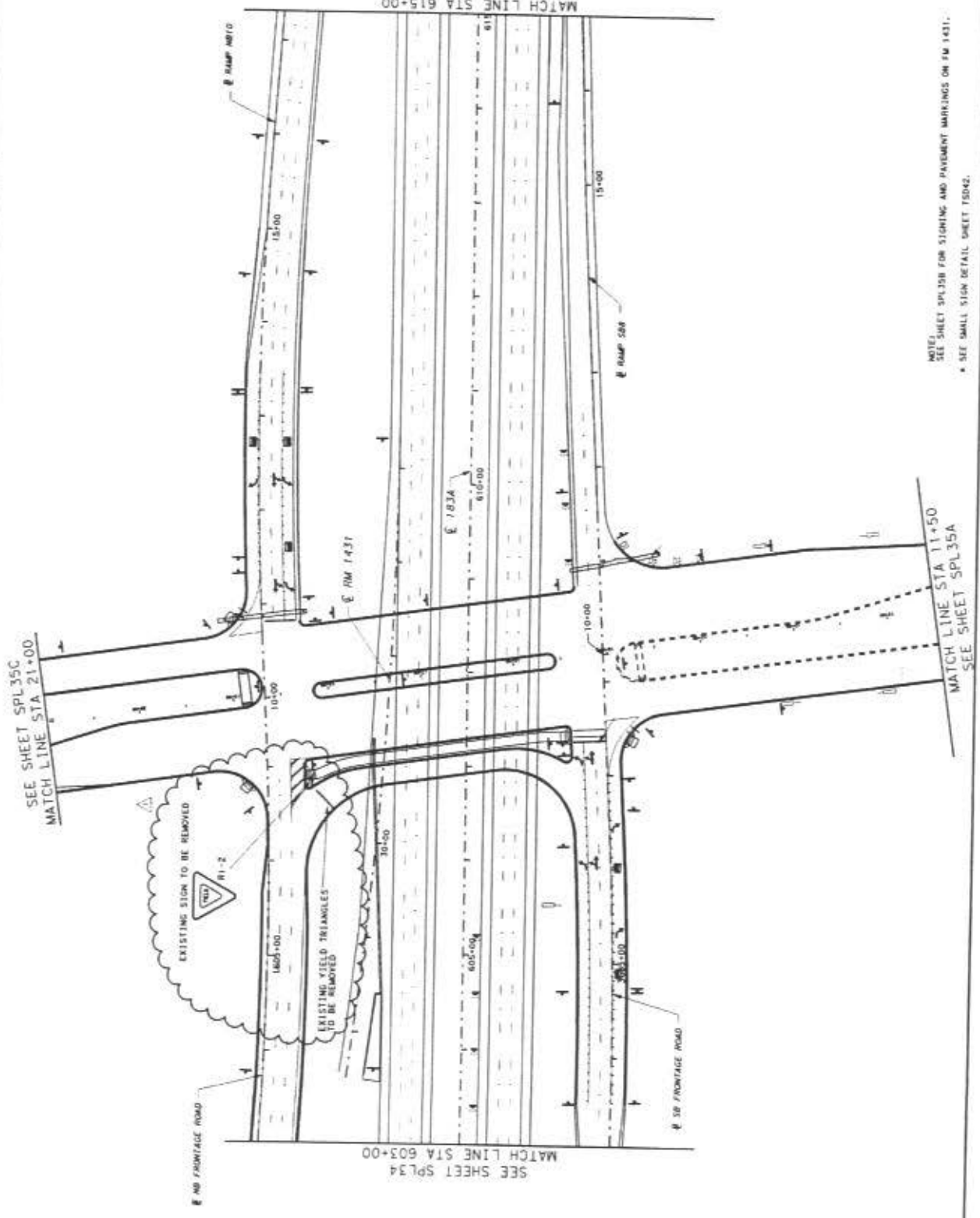

NOTE:
 SEE SHEET SPL30B FOR SIGNING AND PAVEMENT MARKINGS ON FM 1431.
 * SEE SMALL SIGN DETAIL SHEET TSD42.

Exhibit CO.24.4
Preliminary Construction Schedule

Activity ID	Activity Description	Orig Dur	Rem Dur	Activity ID	Early Start	Early Finish	Total Float	Resource	2007											
									JUN	JUL	ADG	SEP	OCT	NOV	DEC					
Dirtwork/Grading																				
Medical Parkway Change Order																				
MED010	CTRMA Board Approval of Medical Parkway CO	0	0	MED010	25JUL07 *		23d	CTRMA	◆ CTRMA Board Approval of Medical Parkway											
MED020	Remove Curb and Gutter East Side - 143 LF	1	1	MED020	26JUL07	26JUL07	23d		Remove Curb and Gutter East Side - 143 LF											
MED140	Traffic Control - Medical Parkway	35 *	35 *	MED140	26JUL07	20SEP07	23d	UR	▬ Traffic Control - Medical Parkway											
MED030	Remove Asphalt and Base East Side NBFR	1	1	MED030	27JUL07	27JUL07	23d		Remove Asphalt and Base East Side NBFR											
MED050	Excavate for Curb along East Side NBFR	1	1	MED050	30JUL07	30JUL07	23d		Excavate for Curb along East Side NBFR											
MED060	Flexbase East Side NBFR - Medical Pkwy CO	2	2	MED060	01AUG07	02AUG07	23d		Flexbase East Side NBFR - Medical Pkwy											
MED070	Hand Place Ty B Asphalt - East Side NBFR - 8 TN	1	1	MED070	03AUG07	03AUG07	23d		Hand Place Ty B Asphalt - East Side NBFR											
MED090	Remove Asphalt and Base West Side NBFR	1	1	MED090	13AUG07	13AUG07	25d		Remove Asphalt and Base West Side NBFR											
MED080	Backfill Backside NBFR Curb - Medical Pkwy CO	2	2	MED080	15AUG07	16AUG07	23d		Backfill Backside NBFR Curb - Medical Pkwy											
MED170	Surface Asphalt Infront Of Curb - East Side NBFR	1	1	MED170	16AUG07	16AUG07	45d		Surface Asphalt Infront Of Curb - East Side NBFR											
MED180	Surface Asphalt Infront of Curb - West Side NBFR	1	1	MED180	17SEP07	17SEP07	26d		Surface Asphalt Infront of Curb - West Side NBFR											
Topsoil Dump/Spread/Finish																				
Medical Parkway Change Order																				
MED120	Strip Topsoil - West Side NBFR	1	1	MED120	14AUG07	14AUG07	25d		Strip Topsoil - West Side NBFR											
MED130	Backfill / Topsoil West Side NBFR	4	4	MED130	14SEP07	20SEP07	23d		▬ Backfill / Topsoil West Side NBFR											
Subcontractors																				
Medical Parkway Change Order																				
MED040	Curb and Gutter East Side - 1500 LF	4	4	MED040	06AUG07	10AUG07	23d	AAC	▬ Curb and Gutter East Side - 1500 LF											
MED100	Open Back Inlets - 15 EA	15	15	MED100	17AUG07	10SEP07	23d	AAC	▬ Open Back Inlets - 15 EA											
MED110	Curb and Gutter West Side NBFR - 1050 LF	3	3	MED110	10SEP07	13SEP07	23d	AAC	▬ Curb and Gutter West Side NBFR											
MED160	Striping - NBFR - Medical Parkway	1	1	MED160	18SEP07	18SEP07	25d	UR	Striping - NBFR - Medical Parkway											
MED150	Signing - Medical Parkway	1	1	MED150	21SEP07	21SEP07	23d	RSI	Signing - Medical Parkway											

Start date 01FEB07
 Finish date 02NOV07
 Data date 13JUL07
 Run date 16JUL07
 Page number 1A

Layout:
 Medical Parkway Change Order

Hill Country Constructors
 183A Turnpike



**Exhibit CO.24.4
Subcontractor Quotes**

PROPOSAL
 AARON CONCRETE CONTRACTORS, LP
 P.O. BOX 27107
 AUSTIN, TX 78755-1107
 (512) 990-2880

TO: Hill Country Constructors US 183 A Turnpike
 ATTN: Domingo
 DATE: May 16, 2007 NBFR Change Order Williamson County

QUANTITY	DESCRIPTION	UNIT PRICE	TOTAL
2,993.00 LF	Curb and Gutter Ty 2	\$12.25 /LF	\$36,664.25
35.00 LF	Concrete Curb Ty 2	\$12.25 /LF	\$428.75
5.00 EA	5' Open Back Inlet Ty C	\$2,050.00 /EA	\$10,250.00
1.00 EA	10' Open Back Inlet Ty C	\$2,875.00 /EA	\$2,875.00
			\$ 50,218.00
6.00 EA	Excavate for Open Back Inlets	\$300.00 /EA	\$1,800.00
6.00 EA	Backfill for Open Back Inlets	\$200.00 /EA	\$1,200.00

INCLUSIONS: 1.) 2 move-ins. Materials, equipment, and labor.

- EXCLUSIONS:
- * Bond
 - * Engineering
 - * Demolition, Excavation, Subgrade Prep, Backfill
 - * Traffic Control
 - * Safety pipe runners at inlets
 - * Sawcutting; asphalt removal

- NOTE:
- Prime Contractor to provide all reference points and grades.
 - Additional move-ins \$650.00/ea.
 - Grades to be from +0.00' to -0.08'.

David Peck
 David Peck

PROPOSAL
AARON CONCRETE CONTRACTORS, LP
P.O. BOX 27107
AUSTIN, TX 78755-1107
(512) 990-2880

TO: Hill Country Constructors
ATTN: Domingo
DATE: June 18, 2007

NBFR Change Order

US 183 A Turnpike
Williamson County

QUANTITY	DESCRIPTION	UNIT PRICE	TOTAL
2,993.00 LF	Curb and Gutter Ty 2 Slipform all	\$10.00 /LF	\$29,930.00
2,993.00 LF	Curb and Gutter Ty 2 Handform all	\$15.50 /LF	\$46,391.50

INCLUSIONS: 1.) 2 move-ins. Materials, equipment, and labor.

EXCLUSIONS: * Bond
* Engineering
* Demolition, Excavation, Subgrade Prep, Backfill
* Traffic Control
* Safety pipe runners at inlets
* Sawcutting; asphalt removal

NOTE: - Prime Contractor to provide all reference points and grades.
- Additional move-ins \$650.00/ea.
- Grades to be from +0.00' to -0.08'.

David Peck

RECEIVED
JUL 09 2007

ROADWAY SPECIALTIES, INC.

P.O. BOX 90309

AUSTIN, TEXAS 78709-0309

PHONE (512) 280-6666

FAX (512) 280-6066

By _____

HILL COUNTRY CONSTRUCTORS
715 DISCOVERY BLVD., SUITE 313
CEDAR PARK, TEXAS 78613

PAST DUE

INVOICE DATE: 05/31/07
INVOICE NO: 0507107
ESTIMATE NO: 11
DATES: 5/1/07-5/31/07
RSI JOB NO: 2991

PHONE: 512-528-2579

FAX: 512-528-2598

OWNER: CENTRAL TEXAS REGIONAL MOBILITY AUTHORITY

PROJECT: US 183-A TURNPIKE PROJECT #: 318815

ITEM DESCRIPTION	UNIT	UNIT PRICE	ORIGINAL CONTRACT QTY	ORIGINAL CONTRACT AMOUNT	CHANCE ORDER QTY	CHANCE ORDER AMOUNT	PREVIOUS ESTIMATE QTY	THIS ESTIMATE QTY	AMOUNT THIS PERIOD	TOTAL TO DATE QTY	TOTAL TO DATE AMOUNT
MATERIAL ON HAND REQUEST - SEE ATTACHED:									88,138.52		181,821.80
MBGF w/ Radius Rail, if reqd	LF	17.27									
MBGF w/Blockouts, Timber Posts	LF	15.27	13,200.00	201,584.00	605.75	9,249.80	13,555.75	250.00	3,817.50	13,805.75	210,813.80
MBGF Transition - Three Deem	CA	1,000.00	40.00	42,400.00	3.00	3,120.00	42.00			42.00	44,520.00
Single Guardrail Terminal Type 1	EA	1,770.00	20.00	35,400.00	50.00	88,500.00	70.00			70.00	123,800.00
Terminal Anchor Section	EA	350.00	20.00	7,000.00	12.00	4,200.00	32.00			32.00	11,200.00
Bridge End Shoe	EA	250.00			2.00	500.00					
Chain Link Fence 6', Galv, 9 ga.	LF	13.25	5,000.00	66,250.00			1.00	1.00	250.00	2.00	500.00
Vehicular Gate - Double 8'x12'	EA	750.00	4.00	3,000.00				2.00			
Post & Cable Fence	LF	7.50	13,000.00	97,500.00							
Barbed Wire Fence Type C	LF	3.78	5,000.00	18,760.00	12,888.00	48,247.50	18,271.80	1,595.00	5,981.25	17,886.80	68,847.50
Barbed Wire Fence Type C End Post	EA	55.00	10.00	550.00							
B.W. Fence Type C Corner/Pull Post	EA	95.00	10.00	950.00	39.00	3,705.00	34.00	15.00	1,425.00	49.00	4,855.00
Gate Type 3	EA	100.00	5.00	500.00							
Woven Wire Fence Type U	LF	3.75	5,000.00	18,750.00							
Woven Wire Fence Type D End Post	EA	55.00	10.00	550.00							
Gate Type 2	EA	250.00	5.00	1,250.00			1.00			1.00	250.00
Change Order Work ordered by John Cornell:											
Carrow Prop: Woven Wire Fence Ty D	LF	3.75			2,010.00	7,587.50	1,970.00			1,970.00	7,387.50
and Addtl price for Special Req Work	LF	1.38			2,010.00	2,773.80	1,970.00			1,970.00	2,718.80
Remove & Replace guardrail	LF	25.00			100.00	2,500.00	37.50	62.50	1,562.50	100.00	2,500.00
Remove & Replace Single Guardrail Term	EA	1,200.00			1.50	1,075.00	1.00	0.50	925.00	1.60	1,875.00
Remove 24' gate & relocate	LS	975.00			1.00	975.00	1.00			1.00	975.00
Remove & relocate 8' chain link fence	LF	13.75			847.00	8,898.25	847.00			847.00	8,898.25
Remove & relocate barrier gate	EA	2,650.00			1.00	2,650.00					
ADD PER SUBCONTRACT MODIFICATION #1 SMALL SIGNS:											
10 BWG SA U	EA	554.00			18.00	9,972.00	18.00	1.00	554.00	17.00	9,418.00
10 BWG SA T	EA	574.00			70.00	40,180.00	44.00	13.00	7,462.00	57.00	32,718.00
10 BWG SA P	EA	164.00			272.00	123,488.00	208.00	45.00	20,884.00	254.00	115,316.00
SCH 80 SA U	EA	684.00			32.00	21,888.00	35.00	2.00	1,368.00	37.00	25,808.00
SCH80 SA T	EA	624.00			14.00	8,736.00	12.00			12.00	7,488.00
SCH80 SA P	EA	582.00			18.00	9,312.00	12.00	1.00	582.00	13.00	7,566.00
10 BWG SA P-BM	EA	584.00			8.00	3,504.00	4.00			4.00	2,336.00
SCH89 (1) SA P-BM	EA	732.00			1.00	732.00					
SCH89 (1) SA U-EXT	EA	776.00			2.00	1,552.00	3.00			3.00	2,328.00
SCH89 (1) SA U-WC	EA	812.00			4.00	3,248.00	1.00			1.00	812.00
Mount Existing Signs	EA	575.00			6.00	3,450.00					
ADD PER SUBCONTRACT MODIFICATION #2:											
AVL Median Barrier Gate	EA	10,050.00			3.00	30,150.00					
Couplings for AVL Gate	EA	105.50			40.00	5,004.00	48.00			48.00	5,084.00
ADD PER QUOTE: Steel Posts	EA	225.00			24.00	5,400.00	21.00	3.00	675.00	24.00	5,400.00
Contract Mod#3: Wrought Iron Fence	LF	37.75			4,500.00	169,875.00	1,018.00	3,484.00	131,521.00	4,500.00	169,875.00
Per Thomas: Drill in Median	HR	200.00			35.50	7,100.00	35.50			35.50	7,100.00
Per Thomas: Replacement drill teeth	EA	8.00			27.00	162.00	27.00			27.00	162.00
Dumpster Fence & Gate	LS	3,388.00			1.00	3,388.00	1.00			1.00	3,388.00
Per C.O. Remove & Replace Sign Base	EA	275.00			24.00	6,600.00		24.00	6,600.00	24.00	6,600.00
Add: Bridge Mounts	EA	2,450.00			2.00	4,900.00		2.00	4,900.00	2.00	4,900.00
Add: Standby time waiting for lane close	HR	18.00			22.00	396.00		22.00	396.00	22.00	396.00
TOTALS				494,414.00		642,825.85			309,867.77		1,117,162.75

Please remit payment to:
Roadway Specialties, Inc.
P.O. Box 90309, Austin, TX 78709
Please include RSI Invoice # on payment.

PROJECT TO DATE		CURRENT MONTH	
TOTAL TO DATE	1,117,162.75	CURRENT BILLING	309,867.77
LESS RETAINGE @ 5%	-55,858.14	CURRENT RETAINAGE	-15,493.39
LESS PREVIOUS INVOICES	-766,030.24	CURRENT DEDUCTS	
AMOUNT DUE THIS ESTIMATE	294,374.38	CURRENT AMOUNT DUE	294,374.38

UNITED I

12909 DESSAU ROAD
AUSTIN, TX 78754

Phone: 512-990-9525 Fax: 512-990-0336

CUSTOMER

HILL COUNTRY CONSTRUCTORS
715 DISCOVERY BLVD SUITE 313
CEDAR PARK, TX 78613

APR 02 2007

Customer.....: 904553
Invoice.....: 128962-012
Invoice Date: 3/30/07
Project#.....: US 183 A
Project Name: US 183 A
PO#.....: CONTRACT
Contact.....: CHRIS JENSEN
Estimator...: PM ONLY
Created by...: URU23CJ
Salesperson...: 5380 - BART LINDHOLM
Terms.....: Net 30 Days

PLEASE REMIT PAYMENT TO:
UNITED RENTALS HIGHWAY TECHNOLOGIES, LP
36353 TREASURY CENTER
CHICAGO, IL 60694-6300

Jobsite Address: US 183 A. AUSTIN, TX 78754

Item Number	Description	UM	Qty	Contract		--Quantities Earned--		----Amount Earned----	
				Unit Price	Amount	To Date	Current	To Date	Current
677 0501	ELIM EXT PAV MRK & MRKR 4"	LF	20979.00	.850	17832.15	20979.00	11333.00 ✓	17832.15	9633.05
678 0501	PAV SURF PREP FOR MRKS (4")	LF	116251.00	.180	20925.18	116251.00	36673.00 ✓	20925.18	6601.14
678 0503	PAV SURF PREP FOR MRKS (8")	LF	12916.00	.350	4520.60	12916.00	2296.00 ✓	4520.60	803.60
678 0504	PAV SURF PREP FOR MRKS (12")	LF	5776.00	.750	4332.00	5776.00	257.00 ✓	4332.00	192.75
678 0507	PAV SURF PREP FOR MRKS (ARROW)	EA	4.00	15.000	60.00	4.00	4.00 ✓	60.00	60.00
678 0508	PAV SURF PREP FOR MRKS (WORD)	EA	4.00	20.000	80.00	4.00	4.00 ✓	80.00	80.00
662 0501	WZ PM REMOV W 4" SLD	LF	17760.00	1.350	23976.00	14508.00	780.00 ✓	19585.80	1053.00
662 0523	WZ PM REMOV Y 4" SLD	LF	19770.00	1.100	21747.00	16645.00	100.00 ✓	18309.50	110.00
662 0569	WZ PM NON-REMOV Y 4" SLD	LF	17557.00	.500	8778.50	17557.00	6044.00 ✓	8778.50	3022.00
168	WZ PM NON-REMOV W 4" SLD	LF	103900.00	.500	51950.00	19356.00	5160.00 ✓	9678.00	2580.00
170	REFL PAV MRK TY I W 4" SLD	LF	200000.00	.280	56000.00	102490.00	47082.00 ✓	28697.20	13182.96
171	REFL PAV MRK TY I W 4" BRK	LF	175000.00	.310	54250.00	45928.00	27658.00 ✓	14237.68	8573.98
172	REFL PAV MRK TY I W 8" SLD	LF	19580.00	.500	9790.00	19580.00	8960.00 ✓	9790.00	4480.00
173	REFL PAV MRK TY I W 12" SLD	LF	5794.00	2.250	13036.50	5794.00	275.00 ✓	13036.50	618.75
174	REFL PAV MRK TY I W 24" SLD	LF	1500.00	5.000	7500.00	683.00	683.00 ✓	3415.00	3415.00
175	REFL PAV MRK TY I W ARROW	EA	20.00	125.000	2500.00	12.00	12.00 ✓	1500.00	1500.00
176	REFL PAV MRK TY I W DBL ARROW	EA	12.00	175.000	2100.00	10.00	10.00 ✓	1750.00	1750.00
177	REFL PAV MRK TY I W WORD	EA	29.00	150.000	4350.00	29.00	29.00 ✓	4350.00	4350.00
178	REFL PAV MRK TY I Y 4" SLD	LF	200000.00	.300	60000.00	120351.00	63926.00 ✓	36105.30	19177.80
179/228	REFL PAV MRK TY II W 4" SLD	FT	120660.00	.180	21718.80	115746.00	40244.00 ✓	20834.28	7243.92
180	REFL PAV MRK TY II (W) (4") (BRK)	FT	63565.00	.180	11441.70	63565.00	13430.00 ✓	11441.70	2417.40
181	REFL PAV MRK TY II (W) (8") (SLD)	FT	23011.00	.350	8053.85	23011.00	12556.00 ✓	8053.85	4394.60
182	REFL PAV MRK TY II W 12" SLD	FT	4059.00	1.250	5073.75	4059.00	257.00 ✓	5073.75	321.25

12909 DESSAU ROAD
AUSTIN, TX 78754
Phone: 512-990-9525 Fax: 512-990-0336

HILL COUNTRY CONSTRUCTORS
715 DISCOVERY BLVD SUITE 313
CEDAR PARK, TX 78613

Customer.....: 904553
Invoice.....: 128962-012
Invoice Date: 3/30/07
Project#.....: US 183 A
Project Name: US 183 A
PO#.....: CONTRACT
Contact.....: CHRIS JENSEN
Estimator...: PM ONLY
Created by...: URU23CJ
Salesperson...: BART LINDHOLM
Terms.....: Net 30 Days

PLEASE REMIT PAYMENT TO:
UNITED RENTALS HIGHWAY TECHNOLOGIES, LP
36353 TREASURY CENTER
CHICAGO, IL 60694-6300

Item Number	Description	UM	Qty	Unit Price	Amount	To Date	Current	To Date	Current
183	REFL PAV MRK TY II W 24" SLD	FT	919.00	2.200	2021.80	919.00	919.00	2021.80	2021.80
184	REFL PAV MRK TY II W ARROW	EA	29.00	60.000	1740.00	29.00	29.00 ✓	1740.00	1740.00
185	REFL PAV MRK TY II W DBL ARROW	EA	12.00	80.000	960.00	12.00	12.00 ✓	960.00	960.00
186	REFL PAV MRK TY II W WORD	EA	29.00	75.000	2175.00	29.00	29.00 ✓	2175.00	2175.00
187	REFL PAV MRK TY II Y 4" SLD	FT	113272.00	.160	18123.52	113272.00	46246.00 ✓	18123.52	7399.36
188	RAIS PAV MRKR CL B TY II-C-R	EA	4000.00	3.950	15800.00	3580.00	2620.00 ✓	14141.00	10349.00
662 0530	WZ PM REMOV Y 12" SLD	LF	866.00	3.300	2857.80	797.00	18.00 ✓	2630.10	59.40
0507	ELIM EXT PAV MRK & MRKR ARROW	EA	18.00	115.000	2070.00	18.00	11.00 ✓	2070.00	1265.00
662 0542	WZ PM REMOV CL B TY I-C	EA	238.00	6.500	1547.00	238.00		1547.00	
662 0543	WZ PM REMOV CL B TY II-A-A	EA	233.00	6.500	1514.50	233.00		1514.50	
677 5018	ELIM EXT PAV MRK & MRKR RPM	EA	30.00	3.500	105.00				
NO PRODUCTION MOBILIZATION ORDERED BY C JENSEN 07/10/06									
662 0524	WZ PM REMOV Y 4" BRK	LF	120.00	1.350	162.00	120.00		162.00	
658 0606	DEL ASM (FLEX)(SURF MOUNT) 42" YELLOW	EA	46.00	56.000	2576.00	46.00		2576.00	
666 0637	REFL PM TY I W 36" YLD TRI	EA	22.00	30.000	660.00	22.00	22.00 ✓	660.00	660.00
666 0639	REFL PM TY II W 36" YLD TRI	EA	22.00	15.000	330.00	22.00	22.00 ✓	330.00	330.00
678 0539	PAV SRF PREP MRKS 36" YLD TRI	EA	7.00	7.500	52.50	7.00	7.00 ✓	52.50	52.50
PKLOT	183A PARKING LOT STRIPING	LS	1.00	1035.000	1035.00	1.00	1.00 ✓	1035.00	1035.00
COM 28	SUPPLY AND INSTALL PARKING LOT SIGNS	EA	4.00	205.000	820.00	4.00	4.00 ✓	820.00	820.00

Total Contract Value 464816.15

Summary	To Date	Current
Total Contract Work	315195.41	124428.25
Tax	.00	.00
Less Retention	15792.11	6221.35
Net Earned	299403.30	118206.91

Notes:
WORK PERFORMED 2/28/07 TO 3/30/07



United Rentals

Highway Technologies

12909 Dessau Road
Austin, Texas 78754

(512) 990-9625
(512) 990-0336 Fax

PROJECT: US 183A LANE CLOSURE ITEMS
Bid Date: JUNE 21, 2007

QUOTE # [5807-23]

CUSTOMER: HILL COUNTRY CONSTRUCTORS
TERMS: 30 DAYS
ATTN: RICH GINDER

LANE CLOSURES:

DESCRIPTION	UNIT	QUANTITY	RATE	
Single Lane Closure Daytime	EA	1	\$350.00	Plus Tax
Single Lane Closure Nighttime	EA	1	\$450.00	Plus Tax
Double Lane Closure Daytime	EA	1	\$550.00	Plus Tax
Double Lane Closure Nighttime	EA	1	\$625.00	Plus Tax
ADD FOR 1 MAN TO REMAIN ON SITE AND MONITOR	EA	1	\$150.00	Plus tax
ADD FOR 1 MESSAGE BOARD	EA	1	\$375.00	Plus tax
ADD FOR 1 TRUCK MOUNTED ATTENUATOR (MANNED)	EA	1	\$475.00	Plus tax

- * Closure rates are based on a maximum of 2 miles, allow \$ 100.00 for each additional mile of channelization,
- * All closures include arrowboard, excludes police, TMA, or Message Boards. (see above).

NOTES AND EXCLUSIONS:

- * ANY CLOSURE SCHEDULED AND NOT CALLED OFF BEFORE CLOSING WILL BE CHARGED 1/2 THE RATE OF THE CLOSURE.
- * Items associated with overhead signs, signals, or beacons is excluded.

We propose to furnish, install, remove upon completion all standard Construction Signs, Barricades, Channelization and Battery Operated Flashing Lights as required by the plans and specifications.

GENERAL:

- * All contracts/work orders are subject to review and amendment based on the conditions and terms of this proposal.
- * This proposal will become an attachment to any contract issued.
- * Bond Premiums, AGC Dues, Pro-ratas and Taxes are not included unless otherwise noted.
- * The quoted prices are valid for 90 days.
- * Acceptance is based on customers account status.
- * Contract extras are not subject to retainage.
- * **NO RETAINAGE ON UNIT DAY CLOSURE ITEMS.**

US 183A CLOSURES (CONTINUED)

* Any subcontracts entered into as a result of this quotation will be bound by the following indemnity clause:

"Subcontractor shall indemnify and save harmless the contractor and its officers, agents, and employees from all suits, actions, losses, damages, claims, or liability of any character, type or description, including without limiting the generality of the foregoing all expenses of litigation, court costs, and attorney's fees provided such claims, damages and reasonable expenses are attributable to injury or death to any person, or injury to any property, received or sustained by any person or persons or property, arising out of, or occasioned by the negligent acts of subcontractor or its agents or employees, in the execution or performance of this contract. Subcontractors obligation to indemnify contractor shall extend only to the percentage of negligence of subcontractor in contributing to such claims, demands, liabilities or reasonable expenses."

SUBMITTED: Bart Lindholm
BART LINDHOLM / SENIOR ESTIMATOR

ACCEPTED: _____
NAME

TITLE

DATE

JOB/PO#

RETAINAGE: YES: NO: PERCENTAGE:
